

# 460 Automated Rotary Blade Grinder



*The Fast And Easy Choice  
For Productivity, Flexibility, Quality, and More!*





# 460 Automated Rotary Blade Grinder

*If you have been looking for a speedy, more productive process to grind your rotary blades, look no further than Foley United's 460 Automatic Rotary Blade Grinder.*

Foley United's NEW 460 Automated Rotary Blade Grinder is the most innovative product to enter the Turfcare Industry in years! The enclosure system for dust and noise, time savings of up to 70%, and the ability to reproduce the OEM grind surface are only a few of the many benefits that the 460 offers. The unique design of the 460 features two grinding heads, automated infeed cycles, and a built-in blade balancing system that makes the grinding process safer and more efficient than ever thought possible!

While the OEM's recommend grinding every eight to ten hours of use for maximum engineered performance, the 460 will reduce your labor, will reduce your effort, and provide the best grind possible for your cutting unit investment. More stress on hydraulics, added strain on your engine, and increased fuel consumption is typical when blades are not sharpened regularly. So, if you are interested in elevating performance, increasing cut quality, and being more productive, step up to the latest technology of Foley United's new 460!

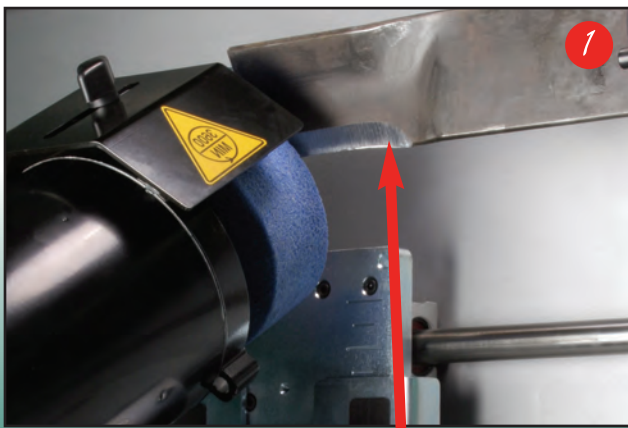

**OEM End of Grind Blend Radius:** A key feature of the 460 is an ability to produce the blend radius that is engineered into all new blades. This unique patent pending feature minimizes blade stress that can be common with other rotary blade grinding systems, and produces a blend-out that is consistent, safe, and effective.



**Safety Enclosure Guard System:** Sliding doors and an enclosed cabinet design minimizes the workshop grinding dust and small particles that are dispersed in the air during the grinding process.

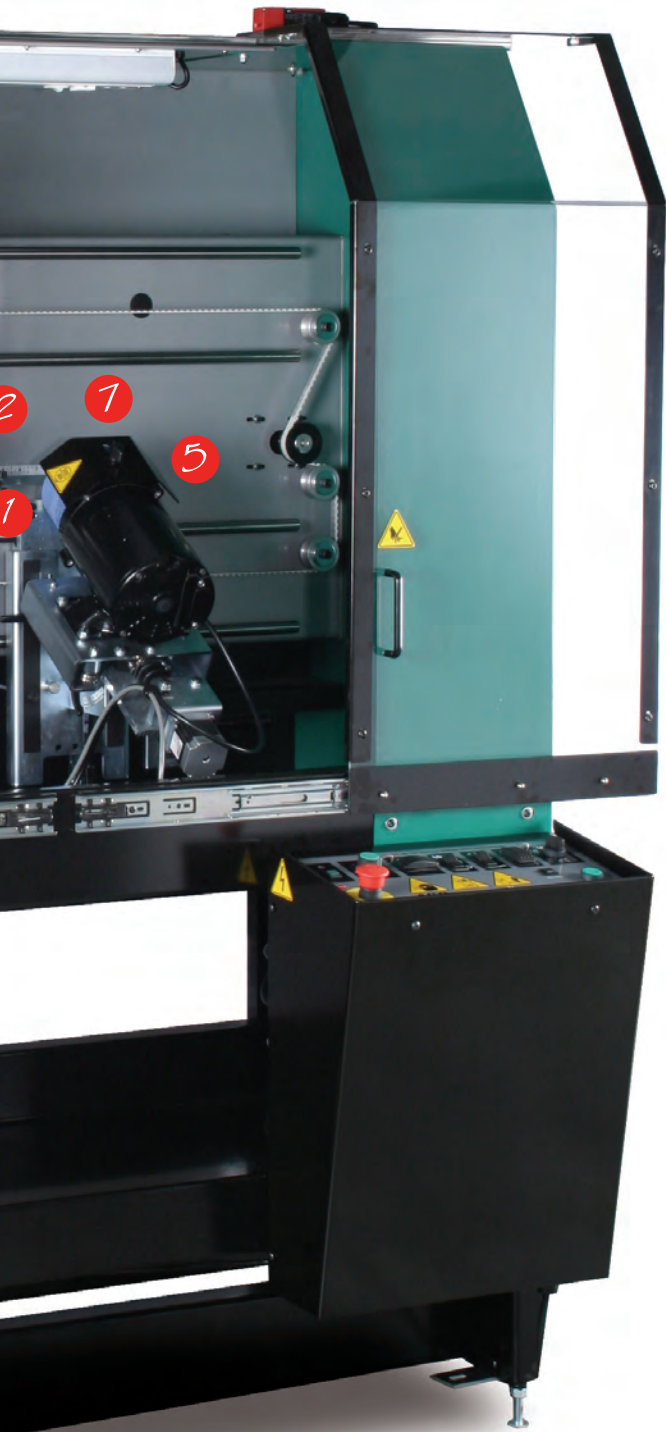

*Patent Pending*



**Built-in Blade Balancing System:** This one-and-only blade balancing design features a knob release that allows for the heavy end of the blade to drop, and when relocked, grinding more on the heavy end is easily done to produce a properly balanced blade.



**Height Adjustment Feature:** This design allows the grinding heads to be adjusted to provide clearance with the various airfoil "lift" designs on the rotary blades.

**Angle Adjustment Feature:** A pivot design allows for angle adjustments to match the OEM specification for the correct grind angle.

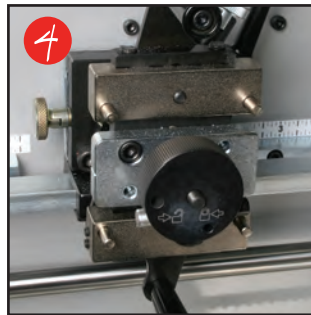

**Center Hole "Quick Connect Cone":** With the push of a button, a cone-shaped mount slides on a threaded stud to securely mount the blade's center hole in the mounting fixture.

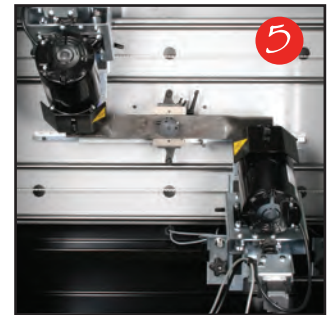

**Dual Grinding Head Design:** Unique design allows for both ends of the blade to be ground evenly and simultaneously.

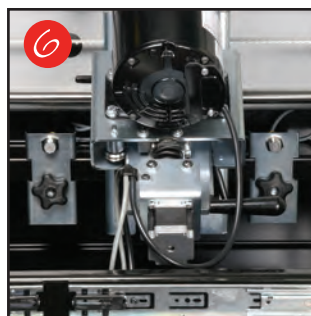

**Proximity Switches:** Coated, durable traverse proximity switches are easily positioned to control the length of travel for the grind area. These allow for the fast repetitive set-up for identical blades, producing a perfect consistent grind each and every time.

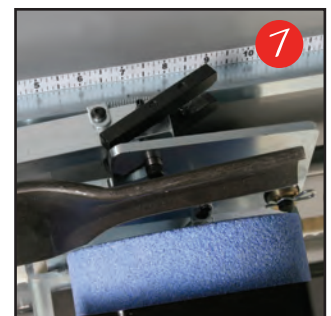

**Blend Radius Relief Slide Bar:** The measuring decal associated with the relief slide bar makes the set-up process extremely fast. This is one of the many features that makes the repeatability of set-up easy, and reduces the amount of time to change from different blade types to mere seconds.

# 460 Automated Rotary Blade Grinder

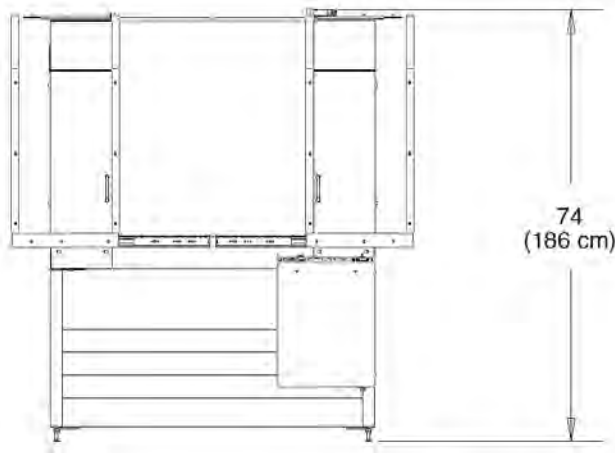

**Front View**

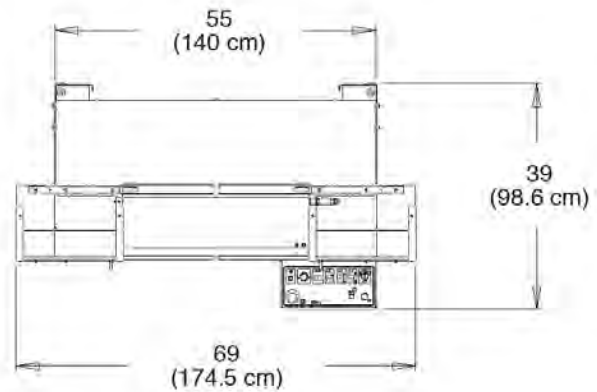

**Top View**

## **Specifications**

Part Number	4600901
Weight	890 pounds (404 kg)
Height	74" (188 cm)
Width	56" (142 cm) doors closed, 69" (175 cm) doors open
Depth	40" (102 cm) machine only
Power	115 vac, 50/60 HZ, single phase, 15 AMP
Grinding Motors	1/2 HP TENV, 3450 RPM 50/60 HZ (2)
Traverse Motor	1/20 HP DC variable speed gearmotor
Maximum Rotary Blade Length	34" (86 cm)

## **Standard Features**

- 5" (127 mm) diameter cupped grinding wheels (2)
- Patent pending dual head and relief radius system
- Structurally engineered steel frame
- Safety guarding standard
- Automatic grind control system

## **Optional Equipment**

- Step down transformer (220v/115v)  
order part number 4600951

*Specifications subject to change without notice.*



*Setting the Standard with the  
World's Most Valued Grinders.*

A Division of Foley-Belsaw  
River Falls, Wisconsin 54022  
[www.foleyunited.com](http://www.foleyunited.com)

**Distributed By:**

3730055  
UTI 284/1-10