



**TORO® TITAN® TINES CATALOG | 2017**



# PLAN YOUR AERATION SCHEDULE TODAY

ORDER YOUR TINES FROM YOUR LOCAL TORO DISTRIBUTOR TODAY TO MAKE SURE YOU'RE READY FOR YOUR AERATION SCHEDULE



# TABLE OF CONTENTS

**TORO**

<b>INTRODUCTION</b> .....	1-2
<b>A TINE TO FIT EVERY APPLICATION</b> .....	2
<b>SELECTION &amp; MEASUREMENT GUIDE</b> .....	3
<b>TINE HEAD IDENTIFICATION GUIDE</b> .....	4
<b>AERATION EVALUATION GUIDE</b> .....	5-6
<b>PROCORE® 648</b> .....	7-11
<b>PROCORE 864/1298</b> .....	12-16
<b>PROCORE 440/660/880</b> .....	17-20
<b>GREENS AERATOR</b> .....	21-23
<b>FAIRWAY AERATOR</b> .....	24-27
<b>TURF AERATOR 686/687</b> .....	28
<b>PROCORE SR SERIES</b> .....	29-37
SR48 .....	30
SR54 .....	31
SR54-S .....	32
SR70 .....	33
SR70-S .....	34
SR72 .....	35
SR75 .....	36-37
<b>TITAN® TINE CONVERSION SLEEVES</b> .....	38
<b>TITAN TINES FOR COMPETITIVE MODELS</b> .....	38-42
<b>QUICK REFERENCE</b> .....	45-48

To order tines call us today: 800-803-8676

# EXACT STANDARDS



## AERATION IMPROVES TURF CONDITIONS

Aeration keeps your turf looking great. It's important to aerate often, especially when it comes to high traffic areas, and with TITAN® TINES on your team you'll know you have the best equipment to meet all of your aeration needs successfully.

### TORO'S FAMILY OF TINES ARE DESIGNED TO MEET YOUR EXACT AERATION NEED

TINE	TIP	LONGEVITY	APPLICATION	WALL THICKNESS
Toro Classic	Standard durable heat treated tip	Good	Good quality in most turf conditions	Thin wall delivers durability and exceptional performance
TITAN	Sharp heat treated tip for improved hole quality and life	Better	Provides superior performance and long lasting wear in most turf conditions	Thin wall delivers durability and exceptional performance
TITAN Max	Sharp carbide tip for excellent hole quality and life	Best	Provides superior performance and long lasting wear in most conditions	Thin wall delivers durability and exceptional performance
TITAN Fairway	Standard heat treated fairway tip for consistent core removal	Better	Provides quality performance in natural soil conditions	Thicker wall provides good hole quality and maximum strength
TITAN HD Fairway	Enhanced hardened tip for 75% longer life than TITAN Fairway	Best	Provides excellent performance and wear in extreme conditions	Thicker wall provides good hole quality and maximum strength

# A TINE TO FIT EVERY APPLICATION

Toro® has about every possible tine you can imagine for the changing seasons and your most demanding turf conditions. TITAN® Tines offer superior quality to provide your grounds the best possible care.

Jump-start your productivity with the TITAN QuickChange™ tine head. The patent-pending taper-lock design makes changing tines a snap. In fact, many users have reduced set-up time by up to 75%. TITAN QuickChange will help you get your aeration done FAST!

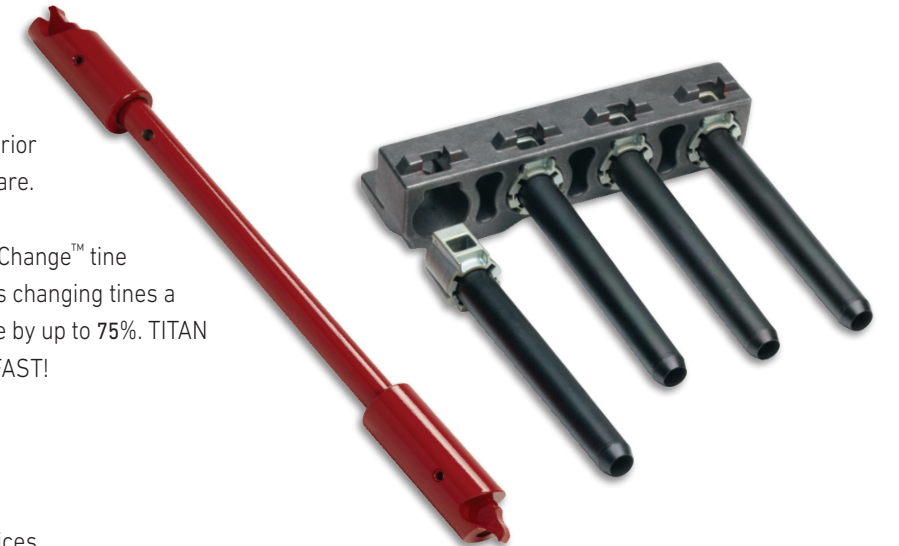

## TORO TITAN TINES OFFER

- Over 150 tines, providing multiple aeration choices
- A wide variety of types meeting your exact aeration requirements
- Higher Productivity: TITAN Max designed with long lasting tungsten carbide blend tip
- Better Performance: TITAN tines last approximately 3-4 times longer than standard tines
- An optimized core, removing more thatch for maximum topdressing
- A superior hole, improving recovery time and maintaining playability
- A tough design, maintaining consistent aeration depth and reducing costly change outs
- 4130/4140 strong alloy combined with unique heat treat process, maximizing strength and resistance to wear
- Durable brazed tip joints for strong bond and resistance to separation and breakage (TITAN Max)

### CORING TINES

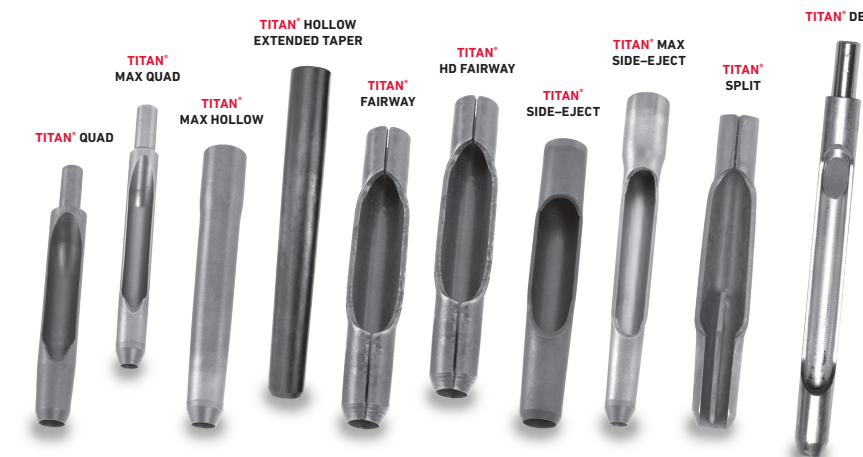

### SOLID TINES



# SELECTION & MEASUREMENT

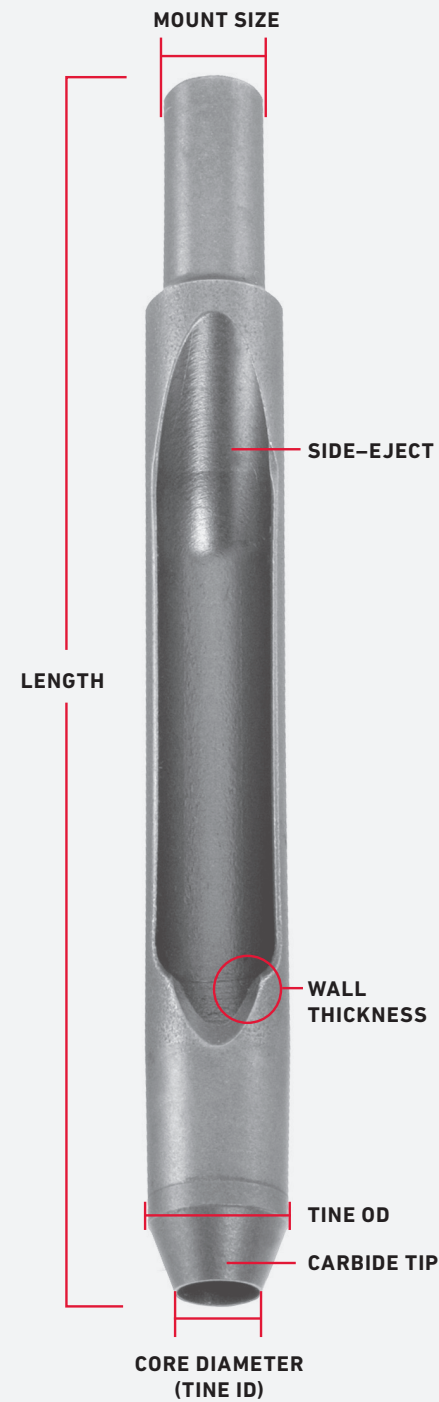

## U.S. STANDARD SIZES

1/4" (.25")	
3/8" (.375")	
1/2" (.5")	
5/8" (.625")	
3/4" (.75")	
7/8" (.875")	

TITAN® TINES fit all current and late model Toro® aerators. Standard mount size fits most competitor equipment. Check mounting size to ensure compatibility. Prices subject to change without notice.

### PROCORE® 648/864/1298 (See pages 7-16)

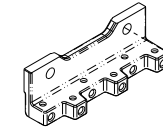

<b>QUAD TINE HEAD (1x6)</b>		
Tine Mount	3/8"	
Qty. of Tines	6	

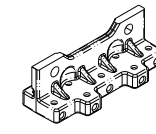

<b>QUAD TINE HEAD (2x5)</b>		
Tine Mount	3/8"	
Qty. of Tines	10	

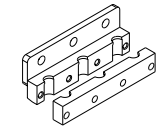

<b>3/4" 3-TINE HEAD</b>		
Tine Mount	3/4"	
Qty. of Tines	3	

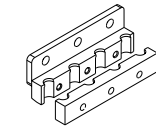

<b>3/4" 4-TINE HEAD</b>		
Tine Mount	3/4"	
Qty. of Tines	4	

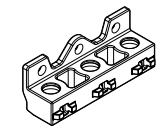

<b>QUICKCHANGE 3-TINE HEAD</b>		
Tine Mount	3/8" or 7/8"	
Qty. of Tines	3	

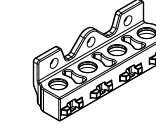

<b>QUICKCHANGE 4-TINE HEAD</b>		
Tine Mount	3/8" or 7/8"	
Qty. of Tines	4	

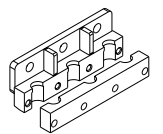

<b>7/8" 3-TINE HD HEAD</b>		
Tine Mount	7/8"	
Qty. of Tines	3	

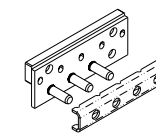

<b>NEEDLE TINE HEAD</b>		
Tine Mount	Needle	
Qty. of Tines	5	

### PROCORE 440/660/880 (See pages 17-20)

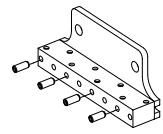

<b>QUAD TINE HEAD (1x6)</b>		
Tine Mount	3/8"	
Qty. of Tines	8	

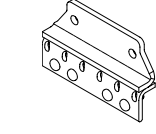

<b>NEEDLE TINE HEAD</b>		
Tine Mount	Needle	
Qty. of Tines	6	

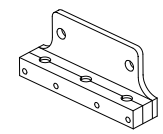

<b>3/4" 3-TINE HEAD</b>		
Tine Mount	3/4"	
Qty. of Tines	3	

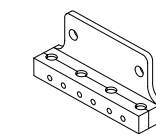

<b>3/4" 4-TINE HEAD</b>		
Tine Mount	3/4"	
Qty. of Tines	4	

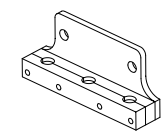

<b>7/8" 3-TINE HEAD</b>		
Tine Mount	7/8"	
Qty. of Tines	3	

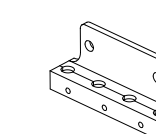

<b>7/8" 4-TINE HEAD</b>		
Tine Mount	7/8"	
Qty. of Tines	4	

### PROCORE SR SERIES (See pages 29-37)

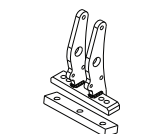

<b>SR54-S / SR70-S</b>		
Tine Mount	5/16" or 12mm	
Qty. of Tines	3 or 4	

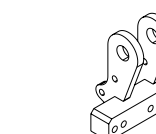

<b>SR54 / SR70</b>		
Tine Mount	5/16" or 12mm	
Qty. of Tines	2 or 3	

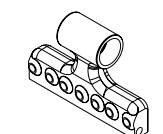

<b>SR48 / SR72</b>		
Tine Mount	5/16" or 12mm	
Qty. of Tines	3 or 4	

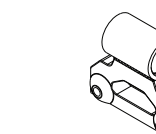

<b>SR75</b>		
Tine Mount	5/16" or 12mm	
Qty. of Tines	2 or 3	

# AERATION EVALUATION GUIDE WITH TINE SELECTION CHART

When you're looking to keep your golf course and grounds in top shape, you need a system that helps you quickly choose the right treatment for your turf needs.

Aeration is the key and the tine selection chart offers you fast answers that convey exactly what you need to do to keep your turf looking great.

The tine selection guide makes it easy to choose and understand the right solution for your golf course and ground needs!



## Preparing for Step One: Find Your Model Number

MODEL CONFIGURATION				
PRODUCT	DESCRIPTION	NO.	LATERAL SPACING	FORWARD SPACING OPTIONS
ProCore® 648 Model 09200	Needle Tine Head	09739	1.60	1.5, 2.0, 2.5
	Quad Tine Head, 2 rows of 5	09736	1.60	2.5
	Quad Tine Head, 1 rows of 6	09737	1.30	1.5, 2.0, 2.5, 3.0
	3 Tine, 3/4" Mount Head	09794	2.60	1.5, 2.0, 2.5, 3.0
	4 Tine, 3/4" Mount Head	09796	2.00	1.5, 2.0, 2.5, 3.0
ProCore 864/1298 Models 09715, 09716	3 Tine HD, 7/8" Mount Head	09797	2.60	1.5, 2.0, 2.5, 3.0
	4 Tine Titan QuickChange	09719	2.00	1.5, 2.0, 2.5, 3.0
	3 Tine Titan QuickChange	09711	2.60	1.5, 2.0, 2.5, 3.0
	Needle Tine Head 660/880	09720	1.20	1.5, 2.0, 2.5
ProCore 440/660/880 Models 09701, 09702	Needle Tine Head 660/880	09720	1.20	1.5, 2.0, 2.5
	Quad Tine Head	09721	1.20	1.5, 2.0, 2.5
	3 Tine, 3/4" Mount Head	09722	3.20	2.0, 2.5, 3.0, 3.5, 4.0, 4.5
	4 Tine, 3/4" Mount Head	09723	2.40	2.0, 2.5, 3.0, 3.5, 4.0, 4.5
	3 Tine, 7/8" Mount Head	09733	3.20	2.0, 2.5, 3.0, 3.5, 4.0, 4.5
	4 Tine, 7/8" Mount Head	09734	2.40	2.0, 2.5, 3.0, 3.5, 4.0, 4.5
Toro Greens Aerator Models 09110, 09120	3/4" Head	59-2500	2.25	2.5
	7/8" Head	62-4610	2.25	2.5
	Needle Head	94-3421	2.25	2.5
	3/8" Head	94-3420	2.25	2.5
Toro Fairway Aerator Models 09500, 09501, 09502			3.50	3.0, 6.0
			5.25	3.0, 6.0

\* Tine depth can vary based on machine set-up.

## DETERMINE THE SURFACE AREA AFFECTED & MATERIAL REMOVED

### STEP ONE FIND HOLES PER SQUARE FOOT

If you know your lateral and forward spacing — See the Holes Per Square Foot chart.

If you are not sure of your forward and lateral spacing, but know your aerator model number use the Preparing for Step One chart on the previous page and pick your spacing options. This table will also help you determine the proper turf holder based on your tine configuration.

#### Step One Example:

- Lateral Spacing = 2.00
- Forward Spacing = 2.00
- Holes Per Square Foot = 36.00

LATERAL SPACING (INCHES)	Forward Spacing (inches)								
	1.0	1.5	2.0	2.5	3.0	3.5	4.0	4.5	6.0
1.20	120.0	80.0	60.0	48.0	40.0	34.3	30.0	26.7	-
1.33	-	72.0	54.1	43.3	36.0	-	-	-	-
1.6	-	-	-	72.0	-	-	-	-	-
2.00	72.0	48.0	36.0	28.8	24.0	-	-	-	-
2.25	-	-	-	25.6	-	-	-	-	-
2.4	60.0	40.0	30.0	24.0	20.0	17.1	15.0	13.3	-
2.5	57.6	38.4	28.8	23.0	19.2	-	-	-	-
3.2	45.0	30.0	22.5	18.0	15.0	12.9	11.3	10.0	-
3.5	-	-	-	-	13.7	-	-	-	-
5.25	-	-	-	-	-	-	-	-	4.6

### STEP TWO DETERMINE TOTAL SURFACE AREA AND VOLUME OF SOIL REMOVED

Take your holes per square foot, core diameter (ID), and the depth\* at which you are aerating.

#### Step Two Example:

- Holes Per Square Feet = 36.00
- Core Diameter = .300"
- Depth = 3.0
- Percent Surface Area Affected = 1.77%
- Volume Removed = 4.42 cu-ft per 1,000 sq/ft

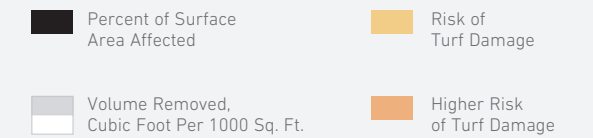

CORE DIAMETER AND DEPTH		HOLES PER SQUARE FOOT (DETERMINED IN STEP ONE)																														
Core Dia.	Depth*	4.6	10.0	11.3	12.9	13.3	13.7	15.0	17.1	18.0	19.2	20.0	22.5	23.0	24.0	25.6	26.7	28.8	30.0	34.3	36.0	38.4	40.0	43.3	45.0	48.0	54.1	57.6	60.0	72.0	80.0	120.0
0.200	1.5	0.10%	0.22%	0.25%	0.28%	0.29%	0.30%	0.33%	0.37%	0.39%	0.42%	0.44%	0.49%	0.50%	0.52%	0.56%	0.58%	0.63%	0.65%	0.75%	0.79%	0.84%	0.87%	0.94%	0.98%	1.05%	1.18%	1.26%	1.31%	1.57%	1.75%	2.62%
	2.0	0.12	0.27	0.31	0.35	0.36	0.37	0.41	0.47	0.49	0.52	0.55	0.61	0.63	0.65	0.70	0.73	0.79	0.82	0.93	0.98	1.05	1.09	1.18	1.23	1.31	1.48	1.57	1.64	1.96	2.18	3.27
	2.5	0.21	0.45	0.51	0.58	0.61	0.62	0.68	0.78	0.82	0.87	0.91	1.02	1.05	1.09	1.16	1.21	1.31	1.36	1.56	1.64	1.75	1.82	1.97	2.05	2.18	2.48	2.62	2.73	3.27	3.64	5.45
	3.0	0.25	0.55	0.61	0.70	0.73	0.75	0.82	0.93	0.98	1.05	1.09	1.23	1.26	1.31	1.40	1.45	1.57	1.64	1.87	1.96	2.09	2.18	2.38	2.45	2.62	2.95	3.14	3.27	3.93	4.36	6.54
	4.0	0.33	0.73	0.82	0.93	0.97	1.00	1.09	1.25	1.31	1.40	1.45	1.64	1.68	1.75	1.86	1.94	2.09	2.18	2.49	2.62	2.79	2.91	3.15	3.27	3.49	3.94	4.19	4.36	5.24	5.82	8.73
0.300	1.5	0.22%	0.49%	0.55%	0.63%	0.65%	0.67%	0.74%	0.84%	0.88%	0.94%	0.98%	1.10%	1.13%	1.18%	1.26%	1.31%	1.41%	1.47%	1.68%	1.77%	1.88%	1.96%	2.13%	2.21%	2.36%	2.64%	2.83%	2.95%	3.53%	3.93%	5.89%
	2.0	0.28	0.61	0.69	0.79	0.82	0.84	0.92	1.05	1.10	1.18	1.23	1.38	1.41	1.47	1.57	1.64	1.77	1.84	2.10	2.21	2.36	2.45	2.66	2.76	2.95	3.32	3.53	3.68	4.42	4.91	7.36
	2.5	0.37	0.82	0.92	1.05	1.09	1.12	1.23	1.40	1.47	1.57	1.64	1.84	1.88	1.96	2.09	2.18	2.36	2.45	2.80	2.95	3.14	3.27	3.54	3.68	3.93	4.43	4.71	4.91	5.89	6.54	9.82
	3.0	0.47	1.02	1.15	1.31	1.36	1.40	1.53	1.70	1.84	1.96	2.05	2.30	2.36	2.45	2.62	2.73	2.95	3.07	3.51	3.68	3.93	4.09	4.43	4.60	4.91	5.54	5.89	6.14	7.36	8.18	12.27
	4.0	0.56	1.23	1.38	1.58	1.64	1.68	1.84	2.10	2.21	2.36	2.45	2.76	2.83	2.95	3.14	3.27	3.53	3.68	4.21	4.42	4.71	4.91	5.31	5.52	5.89	6.64	7.07	7.36	8.84	9.82	14.73
0.400	1.5	0.40%	0.87%	0.98%	1.12%	1.16%	1.20%	1.31%	1.50%	1.57%	1.68%	1.75%	1.96%	2.01%	2.09%	2.23%	2.33%	2.51%	2.62%	2.99%	3.14%	3.35%	3.49%	3.78%	3.93%	4.19%	4.72%	5.03%	5.24%	6.28%	6.98%	10.47%
	2.0	0.50	1.09	1.23	1.40	1.45	1.50	1.64	1.87	1.96	2.09	2.18	2.45	2.51	2.62	2.79	2.91	3.14	3.27	3.74	3.93	4.19	4.36	4.72	4.91	5.24	5.91	6.28	6.54	7.85	8.73	13.09
	2.5	0.66	1.45	1.64	1.87	1.94	1.99	2.18	2.49	2.62	2.79	2.91	3.27	3.35	3.49	3.72	3.88	4.19	4.36	4.99	5.24	5.59	5.82	6.30	6.54	6.98	7.87	8.38	8.73	10.47	11.64	17.45
	3.0	0.83	1.82	2.05	2.34	2.42	2.49	2.73	3.12	3.27	3.49	3.64	4.09	4.19	4.36	4.65	4.85	5.24	5.45	6.23	6.54	6.98	7.27	7.87	8.18	8.73	9.84	10.47	10.91	13.09	14.54	21.82
	4.0	1.00	2.18	2.45	2.80	2.91	2.99	3.27	3.74	3.93	4.19	4.36	4.91	5.03	5.24	5.59	5.82	6.28	6.54	7.48	7.85	8.38	8.73	9.45	9.82	10.47	11.81	12.57	13.09	15.71	17.45	26.18
0.500	1.5	1.16	2.55	2.86	3.27	3.39	3.49	3.82	4.36	4.58	4.89	5.09	5.73	5.86	6.11	6.52	6.79	7.33	7.64	8.73	9.16	9.37	10.18	11.02	11.45	12.22	13.78	14.66	15.27	18.33	20.36	30.54
	2.0	1.33	2.91	3.27	3.74	3.88	3.99	4.36	4.99	5.24	5.59	5.82	6.54	6.70	6.98	7.45	7.76	8.38	8.73	9.97	10.47	11.17	11.64	12.6	13.09	13.96	15.75	16.76	17.45	20.94	23.27	34.91
	2.5	0.62%	1.36%	1.53%	1.75%	1.82%	1.87%	2.05%	2.34%	2.45%	2.62%	2.73%	3.07%	3.14%	3.27%	3.49%	3.64%	3.93%	4.09%	4.67%	4.91%	5.24%	5.45%	5.82%	6.14%	6.54%	7.38%	7.85%	8.18%	9.82%	10.91%	16.36%
	3.0	0.78	1.70	1.92	2.19	2.27	2.34	2.56	2.92	3.07	3.27	3.41	3.83	3.93	4.09	4.36	4.55	4.91	5.11	5.84	6.14	6.54	6.82	7.38	7.67	8.18	9.23	9.82	10.23	12.27	13.64	20.45
	4.0	1.04	2.27	2.56	2.92	3.03	3.12	3.41	3.90	4.09	4.36	4.55	5.11	5.24	5.45	5.82	6.06	6.54	6.82	7.79	8.18	8.73	9.09	9.84	10.23	10.91	12.3	13.09	13.64	16.36	18.18	27.27
0.600	1.5	1.30	2.84	3.20	3.65	3.79	3.90	4.26	4.87	5.11	5.45	5.68	6.39	6.54	6.82	7.27	7.58	8.18	8.52	9.74	10.23	10.91	11.36	12.30	12.78	13.64	15.38	16.36	17.04	20.45	22.73	34.09
	2.0	1.56	3.41	3.83	4.38	4.55	4.67	5.11	5.84	6.14	6.54	6.82	7.67	7.85	8.18	8.73	9.09	9.82	10.23	11.69	12.27	13.09	13.64	14.76	15.34	16.36	18.45	19.63	20.45	24.54	27.27	40.91
	2.5	1.82	3.98	4.47	5.11	5.30	5.45	5.97	6.82	7.16	7.64	7.95	8.95	9.16	9.54	10.18	10.61	11.45	11.93	13.64	14.32	15.27	15.91	17.22	17.90	19.09	21.53	22.91	23.86	28.63	31.82	47.72
	3.0	2.08	4.55	5.11	5.84	6.06	6.23	6.82	7.79	8.18	8.73	9.09	10.23	10.47	10.91	11.64	12.12	13.09	13.64	15.58	16.36	17.45	18.18	19.88	20.45	21.82	24.61	26.18	27.27	32.72	36.36	54.54
	4.0	0.90%	1.96%	2.21%	2.52%	2.62%	2.69%	2.95%	3.37%	3.53%	3.77%	3.93%	4.42%	4.52%	4.71%	5.03%	5.24%	5.65%	5.89%	6.73%	7.07%	7.54%	7.85%	8.50%	8.84%	9.42%	10.63%	11.31%	11.78%	14.14%	15.71%	23.56%
0.700	1.5	1.12	2.45	2.76	3.16	3.27	3.37	3.68	4.21	4.42	4.71	4.91	5.52	5.65	5.89	6.28	6.54	7.07	7.36	8.41	8.84	9.42	9.82	10.63	11.04	11.78	13.29	14.14	14.73	17.67	19.63	29.45
	2.0	1.50	3.27	3.68	4.21	4.36	4.49	4.91	5.61	5.89	6.28	6.54	7.36	7.54	7.85	8.38	8.73	9.42	9.82	11.22	11.7											

# PROCORE® 648



**TINE SELECTION CHART BENEFITS:**

- Speed and ease of use
- Selection of proper turf guard based on aerator and tine configuration needs.
- Quickly identify the amount of soil removed and the percentage of surface area affected.



**FEATURES & BENEFITS**

- 48 inch wide aeration swath
- TrueCore™ ground following system
- Inside wheel placement
- Precision balanced head drive
- RotaLink™ tine guide mechanism
- Series/Parallel 3-wheel drive



The ProCore 648 is an innovative walking aerator from Toro. The rear wheels are within the 48" aeration swath of the machine so the tires are not running over freshly aerated turf. This eliminates the problem of smashing the cores into the holes, preventing topdressing from filling the holes. And easier cleanup produces a savings of time and labor.

**TINE HEADS & TURF GUARDS**

TINE HEADS		TINES REQ'D		TURF GUARDS			
Description	Part No.	Qty.	Part No.	Qty.	Part No.	Qty.	
Needle Tine Head	09739	30	120-1047	2	120-1052	1	
Quad Tine 3/8" Mount Head, 2 rows of 5	09736	60	120-1047	2	120-1052	1	
Quad Tine 3/8" Mount Head, 1 row of 6	09737	36	120-1050	2	120-1053	1	
3 Tine, 3/4" Mount Head	09794	18	120-1044	2	110-4358	1	
4 Tine, 3/4" Mount Head	09796	24	120-1045	2	120-1046	1	
3 Tine HD, 7/8" Mount Head	09797	18	120-1044	2	110-4358	1	
3 Tine, Titan 3/4" or 7/8" Mount QuickChange Head	09711	18	120-1044	2	110-4358	1	
4 Tine, Titan 3/4" or 7/8" Mount QuickChange Head	09719	24	120-1045	2	120-1046	1	

**HELPING GOLF COURSE SUPERINTENDENTS AND GROUNDSKEEPERS EXCEL.**

**3/8" MOUNT**

**TITAN QUAD**

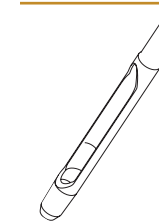

Length	Core Dia. (ID)	OD	Wall Thickness	Part Number
4.50"	.25"	.36"	.052"	108-9104
4.50"	.32"	.46"	.063"	108-9105
4.50"	.41"	.55"	.063"	108-9106
4.50"	.48"	.58"	.049"	108-9293
5.00"	.25"	.36"	.052"	108-9108
5.00"	.32"	.46"	.063"	108-9109
5.00"	.41"	.55"	.063"	108-9110
5.00"	.48"	.58"	.049"	108-9294
5.50"	.41"	.55"	.063"	108-9290

**TITAN SOLID ROUND**

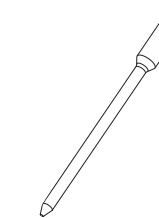

Length	Core Dia. (ID)	OD	Wall Thickness	Part Number
4.50"	–	.20"	–	108-9230
4.50"	–	.25"	–	108-9231
4.50"	–	.30"	–	108-9232
4.50"	–	.38"	–	108-9233
5.50"	–	.20"	–	108-9234
5.50"	–	.25"	–	108-9235
5.50"	–	.30"	–	108-9236
5.50"	–	.38"	–	108-9237

**TITAN SOLID SLICING**



5.00"	–	.63"	–	108-9238
-------	---	------	---	----------

**TITAN CROSS**

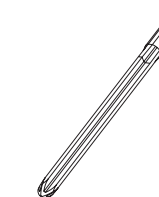

4.50"	–	.38"	–	108-9215
4.50"	–	.50"	–	108-9216
4.50"	–	.62"	–	108-9217
5.50"	–	.38"	–	108-9218
5.50"	–	.50"	–	108-9219
5.50"	–	.62"	–	108-9220

**3/4" MOUNT**

**TITAN HOLLOW**

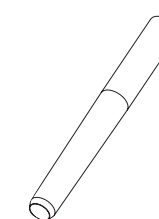

4.75"	.28"	.46"	.058"	108-9128
4.75"	.41"	.56"	.058"	108-9129
4.75"	.53"	.66"	.058"	108-9130
5.75"	.28"	.46"	.058"	108-9132
5.75"	.41"	.56"	.058"	108-9133
5.75"	.53"	.66"	.058"	108-9134
6.50"	.28"	.46"	.058"	108-9138
6.50"	.41"	.56"	.058"	108-9136
6.50"	.53"	.66"	.058"	108-9137

**TITAN HOLLOW EXT. TAPER**

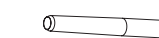

5.75"	.53"	.66"	.058"	114-0551
6.50"	.53"	.66"	.058"	114-0550

**TITAN® Max**

**QUAD MAX**

Part Number	Titan Max Core ID
108-9112	.23"
108-9114	.28"
108-9116	.38"
–	–
108-9120	.23"
108-9122	.28"
108-9124	.38"
–	–
–	–

**CROSS MAX**

–	–
112-1310	–
–	–
–	–
–	–
112-1311	–
–	–

**TITAN® Max**

**HOLLOW MAX**

108-9139	.28"
108-9141	.38"
108-9143	.48"
108-9145	.28"
108-9147	.38"
108-9149	.48"
108-9135	.28"
108-9151	.38"
108-9153	.48"

**HOLLOW EXT. TAPER MAX**

114-0553	.47"
114-0561	.47"





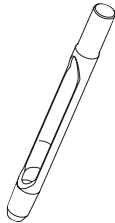

**3/8" MOUNT**

	Length	Core Dia. (ID)	OD	Wall Thickness	Part Number
<b>TITAN QUAD</b>					
	4.50"	.25"	.36"	.052"	108-9104
	4.50"	.32"	.46"	.063"	108-9105
	4.50"	.41"	.55"	.063"	108-9106
	4.50"	.48"	.58"	.049"	108-9293
	5.00"	.25"	.36"	.052"	108-9108
	5.00"	.32"	.46"	.063"	108-9109
	5.00"	.41"	.55"	.063"	108-9110
	5.00"	.48"	.58"	.049"	108-9294
	5.50"	.41"	.55"	.063"	108-9290

**TITAN SOLID ROUND**

	Length	Core Dia. (ID)	OD	Wall Thickness	Part Number
	4.50"	-	.20"	-	108-9230
	4.50"	-	.25"	-	108-9231
	4.50"	-	.30"	-	108-9232
	4.50"	-	.38"	-	108-9233
	5.50"	-	.20"	-	108-9234
	5.50"	-	.25"	-	108-9235
	5.50"	-	.30"	-	108-9236
	5.50"	-	.38"	-	108-9237

**TITAN SOLID SLICING**

	Length	Core Dia. (ID)	OD	Wall Thickness	Part Number
	5.00"	-	.63"	-	108-9238

**TITAN CROSS**

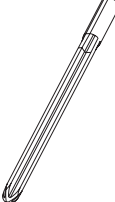
	Length	Core Dia. (ID)	OD	Wall Thickness	Part Number
	4.50"	-	.38"	-	108-9215
	4.50"	-	.50"	-	108-9216
	4.50"	-	.62"	-	108-9217
	5.50"	-	.38"	-	108-9218
	5.50"	-	.50"	-	108-9219
	5.50"	-	.62"	-	108-9220

**3/4" MOUNT**

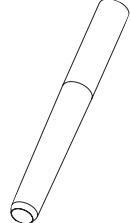
	Length	Core Dia. (ID)	OD	Wall Thickness	Part Number
<b>TITAN HOLLOW</b>					
	4.75"	.28"	.46"	.058"	108-9128
	4.75"	.41"	.56"	.058"	108-9129
	4.75"	.53"	.66"	.058"	108-9130
	5.75"	.28"	.46"	.058"	108-9132
	5.75"	.41"	.56"	.058"	108-9133
	5.75"	.53"	.66"	.058"	108-9134
	6.50"	.28"	.46"	.058"	108-9138
	6.50"	.41"	.56"	.058"	108-9136
	6.50"	.53"	.66"	.058"	108-9137

**TITAN® Max**

Part Number	Titan Max Core ID
<b>QUAD MAX</b>	
108-9112	.23"
108-9114	.28"
108-9116	.38"
-	-
108-9120	.23"
108-9122	.28"
108-9124	.38"
-	-
-	-

-	-
-	-
-	-
-	-
-	-
-	-
-	-
-	-
-	-

**CROSS MAX**

-	-
112-1310	-
-	-
-	-
112-1311	-
-	-

**TITAN® Max**

Part Number	Titan Max Core ID
<b>HOLLOW MAX</b>	
108-9139	.28"
108-9141	.38"
108-9143	.48"
108-9145	.28"
108-9147	.38"
108-9149	.48"
108-9135	.28"
108-9151	.38"
108-9153	.48"

**3/4" MOUNT – CONTINUED**

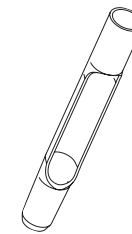
	Length	Core Dia. (ID)	OD	Wall Thickness	Part Number
<b>TITAN HOLLOW EXT. TAPER</b>					
	5.75"	.53"	.66"	.058"	114-0551
	6.50"	.53"	.66"	.058"	114-0550
<b>SIDE EJECT</b>					
	4.75"	.28"	.46"	.058"	108-9159
	4.75"	.41"	.56"	.058"	108-9160
	4.75"	.53"	.66"	.058"	108-9161
	5.75"	.28"	.46"	.058"	108-9163
	5.75"	.41"	.56"	.058"	108-9164
	5.75"	.53"	.66"	.058"	108-9165
	6.50"	.28"	.46"	.058"	108-9162
	6.50"	.41"	.56"	.058"	108-9167
	6.50"	.53"	.66"	.058"	108-9168

**TITAN SIDE EJECT EXT. TAPER**

	5.75"	.53"	.66"	.058"	114-0555
	6.50"	.53"	.66"	.058"	114-0558

**TITAN SPLIT**

	5.75"	.51"	.88"	.120"	112-5122
---	-------	------	------	-------	----------

**TITAN FAIRWAY HD**

	5.75"	.51"	.77"	.120"	108-9260
	5.75"	.51"	.88"	.120"	108-9261

**TITAN FAIRWAY**

	5.75"	.51"	.77"	.120"	104-9876
	5.75"	.51"	.88"	.120"	104-9875

**CLASSIC**

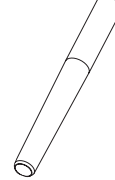
	4.75"	.30"	.44"	.035"	59-3690 Discontinued
	4.75"	.40"	.50"	.049"	66-9140
	4.75"	.50"	.63"	.049"	59-3670
	5.75"	.51"	.63"	.058"	104-0984
	6.50"	.51"	.63"	.058"	106-8943 Discontinued
	6.50"	.39"	.66"	.058"	105-1180

**TITAN® Max**

Part Number	Titan Max Core ID
<b>HOLLOW EXT. TAPER MAX</b>	
114-0553	.47"
114-0561	.47"
<b>SIDE EJECT MAX</b>	
108-9170	.28"
108-9172	.38"
108-9174	.48"
108-9176	.28"
108-9178	.38"
108-9180	.48"
108-9166	.28"
108-9182	.38"
108-9184	.48"

**SIDE EJECT EXT. TAPER MAX**

114-0557	.47"
114-0560	.47"

-	-
---	---

-	-
-	-

-	-
-	-

-	-
-	-
-	-
-	-
-	-
-	-



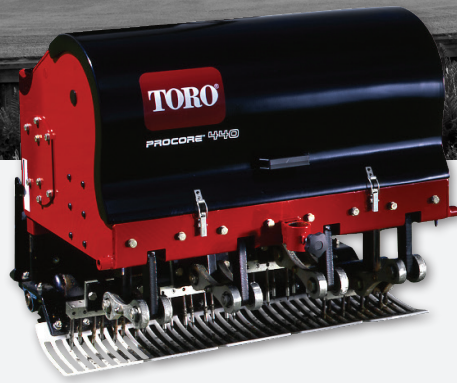

The ProCore 440/660/880 was built for cost-effective aeration during any season. Each model offers performance through the unique Rotalink™ system ensuring proper tine positioning during aeration for consistent and exceptional hole quality. Sizes range from 40" to 80" and can accommodate multiple tine spacing configurations for precise aeration making these models extremely versatile.

### TINE HEADS & TURF GUARDS

TINE HEADS		TINES REQ'D		TURF GUARDS					
Description	Part No.	Qty. 660	Qty. 880	Part No.	Qty. 660	Qty. 880	Part No.	Qty. 660	Qty. 880
Needle Tine Head 660/880	09720	48	64	100-5418	6	-	100-5415	1	-
				100-5419	-	7			
Quad Tine Head, 3/8" Mount	09721	60	80	100-5420	1	5	100-5421	8	4
3 Tine Head, 3/4" Mount	09722	18	24	100-5414	2	5	100-5415	3	-
4 Tine Head, 3/4" Mount	09723	24	32	100-5416	5	1	100-5417	-	4
3 Tine Head, 7/8" Mount	09733	18	24	100-5414	2	5	100-5415	3	-
4 Tine Head, 7/8" Mount	09734	24	32	100-5416	5	1	100-5417	-	4

### 3/8" MOUNT

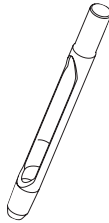
	Length	Core Dia. (ID)	OD	Wall Thickness	Part Number
<i>TITAN QUAD</i> 	4.50"	.25"	.36"	.052"	108-9104
	4.50"	.32"	.46"	.063"	108-9105
	4.50"	.41"	.55"	.063"	108-9106
	4.50"	.48"	.58"	.049"	108-9293
	5.00"	.25"	.36"	.052"	108-9108
	5.00"	.32"	.46"	.063"	108-9109
	5.00"	.41"	.55"	.063"	108-9110
	5.00"	.48"	.58"	.049"	108-9294
	5.50"	.41"	.55"	.063"	108-9290

### TITAN SOLID ROUND

	4.50"	-	.20"	-	108-9230
	4.50"	-	.25"	-	108-9231
	4.50"	-	.30"	-	108-9232
	4.50"	-	.38"	-	108-9233
	5.50"	-	.20"	-	108-9234
	5.50"	-	.25"	-	108-9235
	5.50"	-	.30"	-	108-9236
	5.50"	-	.38"	-	108-9237

### TITAN SOLID SLICING

	5.00"	-	.63"	-	108-9238
---	-------	---	------	---	----------

### TITAN CROSS

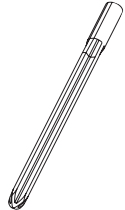
	4.50"	-	.38"	-	108-9215
	4.50"	-	.50"	-	108-9216
	4.50"	-	.62"	-	108-9217
	5.50"	-	.38"	-	108-9218
	5.50"	-	.50"	-	108-9219
	5.50"	-	.62"	-	108-9220

### 3/4" MOUNT

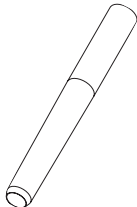
	Length	Core Dia. (ID)	OD	Wall Thickness	Part Number
<i>TITAN HOLLOW</i> 	4.75"	.28"	.46"	.058"	108-9128
	4.75"	.41"	.56"	.058"	108-9129
	4.75"	.53"	.66"	.058"	108-9130
	5.75"	.28"	.46"	.058"	108-9132
	5.75"	.41"	.56"	.058"	108-9133
	5.75"	.53"	.66"	.058"	108-9134

### TITAN<sup>®</sup> Max

Part Number	Titan Max Core ID
<i>QUAD MAX</i>	
108-9112	.23"
108-9114	.28"
108-9116	.38"
-	-
108-9120	.23"
108-9122	.28"
108-9124	.38"
-	-
-	-

-	-
-	-
-	-
-	-
-	-
-	-
-	-
-	-
-	-
-	-

-	-
---	---

### CROSS MAX

-	-
112-1310	-
-	-
-	-
112-1311	-
-	-

### TITAN<sup>®</sup> Max

Part Number	Titan Max Core ID
<i>HOLLOW MAX</i>	
108-9139	.28"
108-9141	.38"
108-9143	.48"
108-9145	.28"
108-9147	.38"
108-9149	.48"

3/4" MOUNT – CONTINUED

	Length	Core Dia. (ID)	OD	Wall Thickness	Part Number
<b>TITAN HOLLOW EXT. TAPER</b>					
	5.75"	.53"	.66"	.058"	114-0551

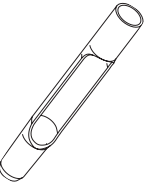
	Length	Core Dia. (ID)	OD	Wall Thickness	Part Number
<b>TITAN SIDE EJECT</b>					
	4.75"	.28"	.46"	.058"	108-9159
	4.75"	.41"	.56"	.058"	108-9160
	4.75"	.53"	.66"	.058"	108-9161
	5.75"	.28"	.46"	.058"	108-9163
	5.75"	.41"	.56"	.058"	108-9164
	5.75"	.53"	.66"	.058"	108-9165

	Length	Core Dia. (ID)	OD	Wall Thickness	Part Number
<b>TITAN SIDE EJECT EXT. TAPER MAX</b>					
	5.75"	.53"	.66"	.058"	114-0555

	Length	Core Dia. (ID)	OD	Wall Thickness	Part Number
<b>TITAN SPLIT</b>					
	5.75"	.51"	.88"	.120"	112-5122

	Length	Core Dia. (ID)	OD	Wall Thickness	Part Number
<b>TITAN FAIRWAY HD</b>					
	5.75"	.51"	.77"	.120"	108-9260
	5.75"	.51"	.88"	.120"	108-9261

	Length	Core Dia. (ID)	OD	Wall Thickness	Part Number
<b>TITAN FAIRWAY</b>					
	5.75"	.51"	.77"	.120"	104-9876
	5.75"	.51"	.88"	.120"	104-9875

	Length	Core Dia. (ID)	OD	Wall Thickness	Part Number
<b>CLASSIC</b>					
	4.75"	.30"	.44"	.035"	59-3690 Discontinued
	4.75"	.40"	.50"	.049"	66-9140
	4.75"	.50"	.63"	.049"	59-3670
	5.75"	.51"	.63"	.058"	104-0984

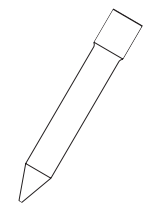
	Length	Core Dia. (ID)	OD	Wall Thickness	Part Number
<b>TITAN SOLID ROUND</b>					
	4.50"	–	.25"	–	108-9198
	4.50"	–	.30"	–	108-9199
	4.50"	–	.35"	–	108-9200
	4.50"	–	.40"	–	108-9201
	4.50"	–	.50"	–	108-9202
	4.50"	–	.60"	–	108-9203
	5.50"	–	.25"	–	108-9204
	5.50"	–	.30"	–	108-9205
	5.50"	–	.35"	–	108-9206
	5.50"	–	.40"	–	108-9207
	5.50"	–	.50"	–	108-9208
	5.50"	–	.60"	–	108-9209
	5.50"	–	.75"	–	108-9244

	Length	Core Dia. (ID)	OD	Wall Thickness	Part Number
<b>TITAN SOLID SLICING</b>					
	4.50"	–	.75"	–	108-9239
	5.50"	–	.75"	–	108-9240

TITAN® Max

Part Number	Titan Max Core ID
114-0553	.47"

	Part Number	Titan Max Core ID
<b>HOLLOW EXT. TAPER MAX</b>		
	108-9170	.28"
	108-9172	.38"
	108-9174	.48"
	108-9176	.28"
	108-9178	.38"
	108-9180	.48"

	Part Number	Titan Max Core ID
<b>SIDE EJECT EXT. TAPER MAX</b>	114-0557	.47"

	Part Number	Titan Max Core ID
<b>TITAN HOLLOW</b>		
	–	–
<b>TITAN SIDE EJECT</b>		
	–	–
<b>TITAN SPLIT</b>		
	–	–
<b>TITAN FAIRWAY HD</b>		
	–	–
<b>TITAN FAIRWAY</b>		
	–	–
<b>CLASSIC</b>		
	–	–
<b>TITAN SOLID ROUND</b>		
	–	–
<b>TITAN SOLID SLICING</b>		
	–	–

3/4" MOUNT – CONTINUED

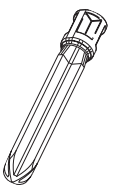
	Length	Core Dia. (ID)	OD	Wall Thickness	Part Number
<b>TITAN CROSS</b>					
	4.50"	–	.50"	–	108-9221
	4.50"	–	.63"	–	108-9222
	4.50"	–	.75"	–	108-9223
	5.50"	–	.50"	–	108-9224
	5.50"	–	.63"	–	108-9225
	5.50"	–	.75"	–	108-9226

7/8" MOUNT

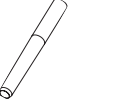
	Length	Core Dia. (ID)	OD	Wall Thickness	Part Number
<b>TITAN HOLLOW</b>					
	4.75"	.51"	.66"	.058"	108-9190
	4.75"	.63"	.76"	.058"	108-9191
	5.75"	.51"	.66"	.058"	108-9192
	5.75"	.63"	.76"	.058"	108-9193

	Length	Core Dia. (ID)	OD	Wall Thickness	Part Number
<b>TITAN SIDE EJECT</b>					
	4.75"	.51"	.66"	.058"	108-9194
	4.75"	.63"	.76"	.058"	108-9195
	5.75"	.51"	.66"	.058"	108-9196
	5.75"	.63"	.76"	.058"	108-9197

	Length	Core Dia. (ID)	OD	Wall Thickness	Part Number
<b>TITAN SPLIT</b>					
	5.75"	.64"	.88"	.120"	112-5121
	5.75"	.64"	.92"	.120"	112-5123

	Length	Core Dia. (ID)	OD	Wall Thickness	Part Number
<b>TITAN FAIRWAY HD</b>					
	5.75"	.64"	.88"	.122"	108-9264
	5.75"	.64"	1.0"	.122"	108-9265

	Length	Core Dia. (ID)	OD	Wall Thickness	Part Number
<b>TITAN FAIRWAY</b>					
	4.75"	.64"	.88"	.122"	92-7941
	5.75"	.64"	.88"	.122"	92-7900
	5.75"	.64"	1.0"	.120"	104-9877

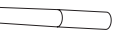
	Length	Core Dia. (ID)	OD	Wall Thickness	Part Number
<b>CLASSIC</b>					
	4.75"	.60"	.75"	.065"	62-4600
	5.75"	.60"	.75"	.065"	86-9720

	Length	Core Dia. (ID)	OD	Wall Thickness	Part Number
<b>TITAN SOLID ROUND</b>					
	5.50"	–	.75"	–	108-9246
	5.50"	–	.88"	–	108-9247

	Length	Core Dia. (ID)	OD	Wall Thickness	Part Number
<b>TITAN SOLID SLICING</b>					
	5.50"	–	.75"	–	108-9242

	Length	Core Dia. (ID)	OD	Wall Thickness	Part Number
<b>TITAN CROSS</b>					
	5.50"	–	.88"	–	108-9259

NEEDLE TINE

	Length	Core Dia. (ID)	OD	Wall Thickness	Part Number
	6.43"	–	5mm	–	100-3620
	7.38"	–	8mm	–	100-3621
	5.43"	–	5mm	–	125-3319

TITAN® Max

Part Number	Titan Max Core ID
112-1312	–
–	–
–	–
112-1313	–
–	–
–	–

TITAN® Max

Part Number	Titan Max Core ID
<b>HOLLOW MAX</b>	
108-9155	.48"
–	–
108-9157	.48"
–	–

	Part Number	Titan Max Core ID
<b>SIDE EJECT MAX</b>		
	108-9186	.48"
	–	–
	108-9188	.48"
	–	–

	Part Number	Titan Max Core ID
<b>TITAN HOLLOW</b>		
	–	–
<b>TITAN SIDE EJECT</b>		
	–	–
<b>TITAN SPLIT</b>		
	–	–
<b>TITAN FAIRWAY HD</b>		
	–	–
<b>TITAN FAIRWAY</b>		
	–	–
<b>CLASSIC</b>		
	–	–
<b>TITAN SOLID ROUND</b>		
	–	–
<b>TITAN SOLID SLICING</b>		
	–	–
<b>TITAN CROSS</b>		
	–	–

# GREENS AERATOR



If there was a Hall of Fame for aerators, the Toro® Greens Aerator would definitely be inducted. This powerful and efficient greens aerator was produced for 17 solid years following its introduction in 1986. Although it's officially in retirement, there are many of them around the world still aerating greens as well as they did brand new.

## TINE HEADS & TURF GUARDS

TINE HEADS		TINES REQ'D	TURF GUARDS	
Description	Part No.		Part No.	Qty. Req'd
3/8" Needle Tine Head	94-3421 Outboard block 94-6822 Inboard block	12		
1/2" Tine Head	94-3420	12	72-4660 (RH) 72-4680 (Ctr) 72-4640 (LH)	1 1 1
3/4" Tine Head	59-2500	12		
7/8" Tine Head	62-4610	12		

## GREENS AERATOR

### 3/8" MOUNT

	Length	Core Dia. (ID)	OD	Wall Thickness	Part Number
	4.50"	.25"	.36"	.052"	108-9104
	4.50"	.32"	.46"	.063"	108-9105
	4.50"	.41"	.55"	.063"	108-9106
	4.50"	.48"	.58"	.049"	108-9293

### TITAN SOLID ROUND

	4.50"	-	.20"	-	108-9230
	4.50"	-	.25"	-	108-9231
	4.50"	-	.30"	-	108-9232
	4.50"	-	.38"	-	108-9233

### TITAN CROSS

	4.50"	-	.38"	-	108-9215
	4.50"	-	.50"	-	108-9216
	4.50"	-	.62"	-	108-9217

### 3/4" MOUNT

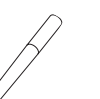
	Length	Core Dia. (ID)	OD	Wall Thickness	Part Number
	4.75"	.28"	.46"	.058"	108-9128
	4.75"	.41"	.56"	.058"	108-9129
	4.75"	.53"	.66"	.058"	108-9130

### TITAN SIDE EJECT

	4.75"	.28"	.46"	.058"	108-9159
	4.75"	.41"	.56"	.058"	108-9160
	4.75"	.53"	.66"	.058"	108-9161

### CLASSIC

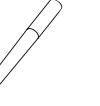
	4.75"	.30"	.44"	.035"	59-3690 Discontinued
	4.75"	.40"	.50"	.049"	66-9140
	4.75"	.50"	.63"	.049"	59-3670

### TITAN SOLID ROUND

	4.50"	-	.25"	-	108-9198
	4.50"	-	.30"	-	108-9199
	4.50"	-	.35"	-	108-9200
	4.50"	-	.40"	-	108-9201
	4.50"	-	.50"	-	108-9202
	4.50"	-	.60"	-	108-9203

### TITAN® Max

Part Number	Titan Max Core ID
<b>QUAD MAX</b>	
108-9112	.23"
108-9114	.28"
108-9116	.38"
-	-

-	-
-	-
-	-
-	-

### CROSS MAX

-	-
112-1310	-
-	-

### TITAN® Max

Part Number	Titan Max Core ID
<b>HOLLOW MAX</b>	
108-9139	.28"
108-9141	.38"
108-9143	.48"

<b>SIDE EJECT MAX</b>	
108-9170	.28"
108-9172	.38"
108-9174	.48"

-	-
-	-
-	-

### SOLID ROUND MAX

-	-
-	-
-	-
-	-
-	-

## GREENS AERATOR

### 3/4" MOUNT – CONTINUED

	Length	Core Dia. (ID)	OD	Wall Thickness	Part Number
--	--------	----------------	----	----------------	-------------

#### TITAN SOLID SLICING

	4.50"	–	.75"	–	108-9239
--	-------	---	------	---	----------

#### TITAN CROSS

	4.50"	–	.50"	–	108-9221
	4.50"	–	.63"	–	108-9222
	4.50"	–	.75"	–	108-9223

### 7/8" MOUNT

	Length	Core Dia. (ID)	OD	Wall Thickness	Part Number
--	--------	----------------	----	----------------	-------------

#### TITAN HOLLOW

	4.75"	.51"	.66"	.058"	108-9190
	4.75"	.63"	.76"	.058"	108-9191

#### TITAN SIDE EJECT

	4.75"	.51"	.66"	.058"	108-9194
	4.75"	.63"	.76"	.058"	108-9195

#### CLASSIC

	4.75"	.60"	.75"	.065"	62-4600
--	-------	------	------	-------	---------

#### TITAN FAIRWAY

	4.75"	.64"	.88"	.122"	92-7941
--	-------	------	------	-------	---------

### NEEDLE TINE

	Length	Core Dia. (ID)	OD	Wall Thickness	Part Number
	6.43"	–	5mm	–	100-3620

### TITAN® Max

Part Number	Titan Max Core ID
-------------	-------------------

–	–
---	---

#### CROSS MAX

112-1312	–
–	–
–	–

### TITAN® Max

Part Number	Titan Max Core ID
-------------	-------------------

HOLLOW MAX	
108-9155	.48"
–	–

#### SIDE EJECT MAX

108-9186	.48"
–	–
–	–

–	–
---	---

# FAIRWAY AERATOR









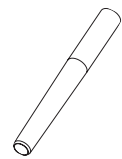

The Fairway Aerator is a legend. Based on the name, one might assume its sole purpose is fairways. However, this tough aerator also performs exceptionally well on sports fields and other turf. Although production ended in 1996, there are still so many Fairway Aerators working today that we've added their tine offering back into the catalog.

### TINE HEADS & TURF GUARDS

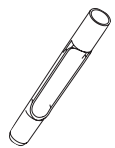
TINE HEADS		TINES REQ'D	TURF GUARDS	
Description	Part No.		Part No.	Qty. Req'd
6-Tine, 3/4" Block		36	70-9430 70-9440	3
Outer	95-3103			
Bridging	95-3104			
Inner	95-3105			
6-Tine, 7/8" Block		12		
Outer	70-9380			
Bridging	70-9390			
Inner	70-9400			

## FAIRWAY AERATOR

### 3/4" MOUNT

	Length	Core Dia. (ID)	OD	Wall Thickness	Part Number
<b>TITAN HOLLOW</b>					
	4.75"	.28"	.46"	.058"	108-9128
	4.75"	.41"	.56"	.058"	108-9129
	4.75"	.53"	.66"	.058"	108-9130
	5.75"	.28"	.46"	.058"	108-9132
	5.75"	.41"	.56"	.058"	108-9133
	5.75"	.53"	.66"	.058"	108-9134
<b>TITAN HOLLOW EXT. TAPER</b>					
	5.75"	.53"	.66"	.058"	114-0551
<b>TITAN SIDE EJECT</b>					
	4.75"	.28"	.46"	.058"	108-9159
	4.75"	.41"	.56"	.058"	108-9160
	4.75"	.53"	.66"	.058"	108-9161
	5.75"	.28"	.46"	.058"	108-9163
	5.75"	.41"	.56"	.058"	108-9164
	5.75"	.53"	.66"	.058"	108-9165
<b>TITAN SIDE EJECT EXT. TAPER</b>					
	5.75"	.53"	.66"	.058"	114-0555
<b>TITAN SPLIT</b>					
	5.75"	.64"	.88"	.120"	112-5122
<b>TITAN FAIRWAY HD</b>					
	5.75"	.51"	.77"	.120"	108-9260
	5.75"	.51"	.88"	.120"	108-9261
<b>TITAN FAIRWAY</b>					
	5.75"	.51"	.77"	.120"	104-9876
	5.75"	.51"	.88"	.120"	104-9875
<b>CLASSIC</b>					
	4.75"	.30"	.44"	.035"	59-3690 Discontinued
	4.75"	.40"	.50"	.049"	66-9140
	4.75"	.50"	.63"	.049"	59-3670
	5.75"	.51"	.63"	.058"	104-0984

### TITAN® Max

Part Number	Titan Max Core ID
<b>HOLLOW MAX</b>	
108-9139	.28"
108-9141	.38"
108-9143	.48"
108-9145	.28"
108-9147	.38"
108-9149	.48"
<b>HOLLOW EXT. TAPER MAX</b>	
114-0553	.47"
<b>SIDE EJECT MAX</b>	
108-9170	.28"
108-9172	.38"
108-9174	.48"
108-9176	.28"
108-9178	.38"
108-9180	.48"
<b>SIDE EJECT EXT. TAPER MAX</b>	
114-0557	.47"
-	-
-	-
-	-
-	-
-	-
-	-
-	-

## FAIRWAY AERATOR

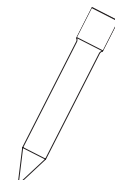
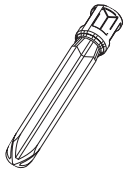

### 3/4" MOUNT – CONTINUED

	Length	Core Dia. (ID)	OD	Wall Thickness	Part Number
<b>TITAN SOLID ROUND</b>					
	4.50"	-	.25"	-	108-9198
	4.50"	-	.30"	-	108-9199
	4.50"	-	.35"	-	108-9200
	4.50"	-	.40"	-	108-9201
	4.50"	-	.50"	-	108-9202
	4.50"	-	.60"	-	108-9203
	5.50"	-	.25"	-	108-9204
	5.50"	-	.30"	-	108-9205
	5.50"	-	.35"	-	108-9206
	5.50"	-	.40"	-	108-9207
	5.50"	-	.50"	-	108-9208
	5.50"	-	.60"	-	108-9209
	5.50"	-	.75"	-	108-9244
<b>TITAN CROSS</b>					
	4.50"	-	.50"	-	108-9221
	4.50"	-	.63"	-	108-9222
	4.50"	-	.75"	-	108-9223
	5.50"	-	.50"	-	108-9224
	5.50"	-	.63"	-	108-9225
	5.50"	-	.75"	-	108-9226

### TITAN® Max

Part Number	Titan Max Core ID
-	-
-	-
-	-
-	-
-	-
-	-
-	-
-	-
-	-
-	-
-	-
-	-
-	-
-	-
-	-
-	-
-	-
<b>HOLLOW MAX</b>	
112-1312	-
-	-
-	-
112-1313	-
-	-
-	-

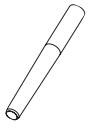
### 7/8" MOUNT

	Length	Core Dia. (ID)	OD	Wall Thickness	Part Number
<b>TITAN HOLLOW</b>					
	4.75"	.51"	.66"	.058"	108-9190
	4.75"	.63"	.76"	.058"	108-9191
	5.75"	.51"	.66"	.058"	108-9192
	5.75"	.63"	.76"	.058"	108-9193
<b>TITAN SIDE EJECT</b>					
	4.75"	.51"	.66"	.058"	108-9194
	4.75"	.63"	.76"	.058"	108-9195
	5.75"	.51"	.66"	.058"	108-9196
	5.75"	.63"	.76"	.058"	108-9197
<b>TITAN SPLIT</b>					
	5.75"	.64"	.88"	.120"	112-5121
	5.75"	.64"	.92"	.120"	112-5123

### TITAN® Max

Part Number	Titan Max Core ID
<b>HOLLOW MAX</b>	
108-9155	.48"
-	-
108-9157	.48"
-	-
<b>SIDE EJECT MAX</b>	
108-9186	.48"
-	-
108-9188	.48"
-	-
-	-
-	-
-	-





# PROCORE® SR SERIES



### FEATURES & BENEFITS

- Heavy-duty design
- Hydraulic remote depth adjustment from the tractor
- Superior punching power
- Multiple coring and solid tines
- Easy hook-up and operation
- Simplified maintenance



The ProCore SR Series provide working widths of 48" – 75" (122 – 190 cm), working depths up to 16" (40.6 cm) and hole spacing from 2.5" – 6" (6.3 – 15.2 cm). From lightweight, precision machines for more sensitive turf to robust heavy-duty machines to break up the soil on the most compacted surfaces, the ProCore SR Series deep tine aerators are the ultimate choice for performance and quality.

### 12MM OR 18MM MOUNT

	Mount	Length	Core Dia. (ID)	OD	Part	Adapter Sleeve	Replacement Tube
<i>CORING TINES</i>							
	12mm	7.00"	.52"	.69"	SGC07625*	–	SGT07625
	12mm	7.00"	.56"	.81"	SGC07750*	–	SGT07750
	12mm	10.00"	.56"	.75"	SGC10755*	–	SGT10750
	12mm	10.00"	.56"	.81"	SGC10813H	–	SGT10813H
	18mm	8.00"	.94"	1.31"	SGC08125	–	SGT08125
	18mm	8.00"	.74"	1.06"	SGC08100H	–	SGT08100H
	18mm	10.00"	.56"	.75"	SGC10750	–	SGT10750
	18mm	10.00"	.74"	1.06"	SGC10100H	–	SGT10100H
	18mm	10.00"	.76"	1.00"	SGC10100S	–	SGT10100S
	18mm	12.00"	.94"	1.31"	SGC12125	–	SGT12125

### SOLID TINES

	5/16"	8.50"	–	.31"	SGS07313	SGA08313	–
	5/16"	10.00"	–	.31"	SGS08313	SGA08313	–
	3/8"	9.00"	–	.38"	SGS08375	SGA12375	–
	3/8"	10.75"	–	.38"	SGS10374	SGA12375	–
	3/8"	12.25"	–	.38"	SGS10375	SGA12375	–
	12mm	8.00"	–	12mm	SGS08500	–	–
	12mm	10.75"	–	12mm	SGS10504	–	–
	12mm	12.25"	–	12mm	SGS10500	–	–
	12mm	14.25"	–	12mm	SGS12500	–	–
	12mm	16.25"	–	12mm	SGS14500	–	–
	18mm	12.25"	–	18mm	SGS10750	–	–
	18mm	12.50"	–	18mm	SGS10875	–	–
	18mm	14.00"	–	18mm	SGS12875	–	–
	18mm	14.25"	–	18mm	SGS12750	–	–
	18mm	16.00"	–	18mm	SGS14875	–	–
	18mm	16.25"	–	18mm	SGS14750	–	–

### SR48 ADAPTER HEAD KIT 117-7190

#### SOLID TINES

	5/16"	8.50"	–	.31"	SGS07313	–	–
	5/16"	10.00"	–	.31"	SGS08313	–	–

### SR48 ADAPTER HEAD KIT 117-7191

#### CORING TINES

	12mm	7.00"	.52"	.69"	SGC07624	–	SGT07625
	12mm	7.00"	.56"	.81"	SGC07754	–	SGT07750
	12mm	10.00"	.56"	.75"	SGC10754	–	SGT10750

#### SOLID TINES

	12mm	8.00"	–	12mm	SGS08500	–	–
	12mm	12.25"	–	12mm	SGS10500	–	–
	12mm	14.25"	–	12mm	SGS12500	–	–
	12mm	16.25"	–	12mm	SGS14500	–	–

\*Longer shank tine.

**5/16" OR 12MM MOUNT**

Mount	Length	Core Dia. (ID)	OD	Part	Adapter Sleeve	Replacement Tube
<i>CORING TINES</i>						
3/8"	5.50"	.38"	.50"	SGC05550	SGA10375	-
12mm	7.00"	.52"	.69"	SGC07624	-	SGT07625
12mm	7.00"	.56"	.81"	SGC07754	-	SGT07750
12mm	10.00"	.56"	.75"	SGC10754	-	SGT10750
<i>SOLID TINES</i>						
5/16"	8.50"	-	.31"	SGS07313	-	-
5/16"	10.00"	-	.31"	SGS08313	-	-
3/8"	9.00"	-	.38"	SGS08375	SGA10375	-
3/8"	10.75"	-	.38"	SGS10374	SGA10375	-
12mm	8.00"	-	12mm	SGS08500	-	-
12mm	10.75"	-	12mm	SGS10504	-	-

**SR 54 ADAPTER HEAD KIT 117-7193 (36 TINES)**

<i>CORING TINES</i>						
3/8"	5.50"	.38"	.50"	SGC05550	-	SGT05550
<i>SOLID TINES</i>						
5/16"	8.50"	-	.31"	SGS07313	-	-
5/16"	10.00"	-	.31"	SGS08313	-	-
3/8"	9.00"	-	.38"	SGS08375	SGA10375	-
3/8"	10.75"	-	.38"	SGS10374	SGA10375	-
3/8"	12.25"	-	.38"	SGS10375	SGA10375	-

**5/16" OR 12MM MOUNT**

Mount	Length	Core Dia. (ID)	OD	Part	Adapter Sleeve	Replacement Tube
<i>CORING TINES</i>						
12mm	7.00"	.52"	.69"	SGC07624	-	SGT07625
12mm	7.00"	.56"	.81"	SGC07754	-	SGT07750
12mm	10.00"	.56"	.75"	SGC10754	-	SGT10750
<i>SOLID TINES</i>						
5/16"	8.50"	-	.31"	SGS07313	-	-
5/16"	10.00"	-	.31"	SGS08313	-	-
12mm	8.00"	-	12mm	SGS08500	-	-
12mm	10.75"	-	12mm	SGS10504	-	-

**SR 54-S ADAPTER HEAD KIT 117-7194 (12 TINES)**

<i>SOLID TINES</i>						
18mm	12.25"	-	18mm	SGS10750	-	-

**SR 54-S ADAPTER HEAD KIT 117-7195 (12 TINES)**

<i>CORING TINES</i>						
12mm	7.00"	.52"	.69"	SGC07624	-	SGT07625
12mm	7.00"	.56"	.81"	SGC07754	-	SGT07750
12mm	10.00"	.56"	.75"	SGC10754	-	SGT10750
<i>SOLID TINES</i>						
5/16"	8.50"	-	.31"	SGS07313	-	-
5/16"	10.00"	-	.31"	SGS08313	-	-
12mm	8.00"	-	12mm	SGS08500	-	-
12mm	10.75"	-	12mm	SGS10504	-	-

**SR 54-S ADAPTER HEAD KIT 117-7196 (24 TINES)**

<i>CORING TINES</i>						
3/8"	5.50"	.38"	.50"	SGC05550	-	SGT05550
<i>SOLID TINES</i>						
5/16"	8.50"	-	.31"	SGS07313	-	-
5/16"	10.00"	-	.31"	SGS08313	-	-
3/8"	9.00"	-	.38"	SGS08375	-	-
3/8"	10.75"	-	.38"	SGS10374	-	-

**SR 54-S ADAPTER HEAD KIT 117-7199 (48 TINES)**

<i>CORING TINES</i>						
3/8"	5.50"	.38"	.50"	SGC05550	-	SGT05550
<i>SOLID TINES</i>						
3/8"	9.00"	-	.38"	SGS08375	-	-
3/8"	10.75"	-	.38"	SGS10374	-	-

**5/16" OR 12MM MOUNT**

Mount	Length	Core Dia. (ID)	OD	Part	Adapter Sleeve	Replacement Tube
<i>CORING TINES</i>						
3/8"	5.50"	.38"	.50"	SGC05550	SGA10375	SGT05550
12mm	7.00"	.52"	.69"	SGC07624	-	SGT07625
12mm	7.00"	.56"	.81"	SGC07754	-	SGT07750
12mm	10.00"	.56"	.75"	SGC10754	-	SGT10750
<i>SOLID TINES</i>						
5/16"	8.50"	-	.31"	SGS07313	-	-
5/16"	10.00"	-	.31"	SGS08313	-	-
3/8"	9.00"	-	.38"	SGS08375	SGA10375	-
3/8"	10.75"	-	.38"	SGS10374	SGA10375	-
12mm	8.00"	-	12mm	SGS08500	-	-
12mm	10.75"	-	12mm	SGS10504	-	-

**SR70 ADAPTER HEAD KIT 117-7193 (48 TINES)**

<i>CORING TINES</i>						
3/8"	5.50"	-	.50"	SGC05550	-	-
<i>SOLID TINES</i>						
5/16"	8.50"	-	.3125"	SGS07313	-	-
5/16"	10.00"	-	.3125"	SGS08313	-	-
3/8"	9.00"	-	.375"	SGS08375	-	-
3/8"	10.75"	-	.375"	SGS10374	-	-
3/8"	12.25"	-	.375"	SGS10375	-	-

**5/16" OR 12MM MOUNT**

Mount	Length	Core Dia. (ID)	OD	Part	Adapter Sleeve	Replacement Tube
<i>CORING TINES</i>						
12mm	7.00"	.52"	.69"	SGC07624	-	SGT07625
12mm	7.00"	.56"	.81"	SGC07754	-	SGT07750
12mm	10.00"	.56"	.75"	SGC10754	-	SGT10750
<i>SOLID TINES</i>						
5/16"	8.50"	-	.3125"	SGS07313	-	-
5/16"	10.00"	-	.3125"	SGS08313	-	-
12mm	8.00"	-	12mm	SGS08500	-	-
12mm	10.75"	-	12mm	SGS10504	-	-

**SR70-S ADAPTER HEAD KIT 117-7194 (16 TINES)**

<i>SOLID TINES</i>						
18mm	12.25"	-	18mm	SGS10750	-	-

**SR70-S ADAPTER HEAD KIT 117-7195 (16 TINES)**

<i>CORING TINES</i>						
12mm	7.00"	.52"	.69"	SGC07624	-	SGT07625
12mm	7.00"	.56"	.81"	SGC07754	-	SGT07750
12mm	10.00"	.56"	.75"	SGC10754	-	SGT10750
<i>SOLID TINES</i>						
5/16"	8.50"	-	.3125"	SGS07313	-	-
5/16"	10.00"	-	.3125"	SGS08313	-	-
12mm	8.00"	-	12mm	SGS08500	-	-
12mm	10.75"	-	12mm	SGS10504	-	-

**SR70-S ADAPTER HEAD KIT 117-7196 (32 TINES)**

<i>CORING TINES</i>						
3/8"	5.50"	.38"	.50"	SGC05550	-	SGT05550
<i>SOLID TINES</i>						
5/16"	8.50"	-	.3125"	SGS07313	-	-
5/16"	10.00"	-	.3125"	SGS08313	-	-
3/8"	9.00"	-	.375"	SGS08375	-	-
3/8"	10.75"	-	.375"	SGS10374	-	-

**SR70-S ADAPTER HEAD KIT 117-7199 (64 TINES)**

<i>CORING TINES</i>						
3/8"	5.50"	.38"	.50"	SGC05550	-	SGT05550
<i>SOLID TINES</i>						
3/8"	9.00"	-	.375"	SGS08375	-	-
3/8"	10.75"	-	.375"	SGS10374	-	-

**12MM OR 18MM MOUNT**

Mount	Length	Core Dia. (ID)	OD	Part	Adapter Sleeve	Replacement Tube
<i>CORING TINES</i>						
12mm Long	7.00"	.52"	.69"	SGC07625*	-	SGT07625
12mm Long	7.00"	.56"	.81"	SGC07750*	-	SGT07750
12mm Long	10.00"	.56"	.75"	SGC10755*	-	SGT10750
12mm Long	10.00"	.56"	.81"	SGC10813H	-	SGT10813H
18mm Long	8.00"	.94"	1.31"	SGC08125	-	SGT08125
18mm Long	8.00"	.74"	1.06"	SGC08100H	-	SGT08100H
18mm Long	10.00"	.56"	.75"	SGC10750	-	SGT10750
18mm Long	10.00"	.74"	1.06"	SGC10100H	-	SGT10100H
18mm Long	10.00"	.76"	1.00"	SGC10100S	-	SGT10100S
18mm Long	12.00"	.94"	1.31"	SGC12125	-	SGT12125

Mount	Length	Core Dia. (ID)	OD	Part	Adapter Sleeve	Replacement Tube
<i>SOLID TINES</i>						
5/16"	8.50"	-	.3125"	SGS07313	SGA08313	-
5/16"	10.00"	-	.3125"	SGS08313	SGA08313	-
3/8"	9.00"	-	.375"	SGS08375	SGA12375	-
3/8"	10.75"	-	.375"	SGS10374	SGA12375	-
3/8"	12.25"	-	.375"	SGS10375	SGA12375	-
12mm	8.00"	-	12mm	SGS08500	-	-
12mm	10.75"	-	12mm	SGS10504	-	-
12mm	12.25"	-	12mm	SGS10500	-	-
12mm	14.25"	-	12mm	SGS12500	-	-
12mm	16.25"	-	12mm	SGS14500	-	-
18mm	12.25"	-	18mm	SGS10750	-	-
18mm	12.50"	-	18mm	SGS10875	-	-
18mm	14.00"	-	18mm	SGS12875	-	-
18mm	14.25"	-	18mm	SGS12750	-	-
18mm	16.00"	-	18mm	SGS14875	-	-
18mm	16.25"	-	18mm	SGS14750	-	-

**SR72 ADAPTER HEAD KIT 117-7190 (60 TINES)**

Mount	Length	Core Dia. (ID)	OD	Part	Adapter Sleeve	Replacement Tube
<i>SOLID TINES</i>						
5/16"	8.50"	-	.3125"	SGS07313	-	-
5/16"	10.00"	-	.3125"	SGS08313	-	-

**SR72 ADAPTER HEAD KIT 117-7191 (60 TINES)**

Mount	Length	Core Dia. (ID)	OD	Part	Adapter Sleeve	Replacement Tube
<i>CORING TINES</i>						
12mm	7.00"	.52"	.69"	SGC07624	-	SGT07625
12mm	7.00"	.56"	.81"	SGC07754	-	SGT07750
12mm	10.00"	.56"	.75"	SGC10754	-	SGT10750

Mount	Length	Core Dia. (ID)	OD	Part	Adapter Sleeve	Replacement Tube
<i>SOLID TINES</i>						
12mm	8.00"	-	12mm	SGS08500	-	-
12mm	12.25"	-	12mm	SGS10500	-	-
12mm	14.25"	-	12mm	SGS12500	-	-
12mm	16.25"	-	12mm	SGS14500	-	-

\*Longer shank tine.

Prices subject to change without notice.

**7/8" MOUNT**

Mount	Length	Core Dia. (ID)	OD	Part	Adapter Sleeve	Replacement Tube
<i>CORING TINES</i>						
18mm Long	8.00"	.94"	1.31"	SGC08125	SG715802	SGT08125
18mm Long	8.00"	.74"	1.06"	SGC08100H	SG715802	SGT08100H
18mm Long	10.00"	.56"	.75"	SGC10750	SG715802	SGT10750
18mm Long	10.00"	.74"	1.06"	SGC10100H	SG715802	SGT10100H
18mm Long	10.00"	.76"	1.00"	SGC10100S	SG715802	SGT10100S
18mm Long	12.00"	.94"	1.31"	SGC12125	SG715802	SGT12125
7/8"	8.00"	.94"	1.31"	SGC08123	-	SGT08125
7/8"	12.00"	.94"	1.31"	SGC12123	-	SGT12125

Mount	Length	Core Dia. (ID)	OD	Part	Adapter Sleeve	Replacement Tube
<i>SOLID TINES</i>						
18mm	12.25"	-	18mm	SGS10750	SG715802	-
18mm	12.50"	-	.875"	SGS10875	SG715802	-
18mm	14.00"	-	.875"	SGS12875	SG715802	-
18mm	14.25"	-	18mm	SGS12750	SG715802	-
18mm	16.00"	-	.875"	SGS14875	SG715802	-
18mm	16.25"	-	18mm	SGS14750	SG715802	-
7/8"	12.50"	-	.875"	SGS10876	-	-
7/8"	14.00"	-	.875"	SGS12876	-	-
7/8"	15.75"	-	.875"	SGS14876	-	-
7/8"	17.88"	-	1.00"	SGS16100	-	-

**SR75 ADAPTER HEAD KIT 117-7198 (4X12MM = 24 TINES OR 3X18MM = 18 TINES)**

Mount	Length	Core Dia. (ID)	OD	Part	Adapter Sleeve	Replacement Tube
<i>CORING TINES</i>						
12mm Long	7.00"	.52"	.69"	SGC07625*	-	SGT07625
12mm Long	7.00"	.56"	.81"	SGC07750*	-	SGT07750
12mm Long	10.00"	.56"	.81"	SGC10813H	-	SGT10813H
12mm Long	10.00"	.56"	.75"	SGC10755*	-	SGT10750
18mm Long	8.00"	.74"	1.06"	SGC08100H	-	SGT08100H
18mm Long	8.00"	.94"	1.31"	SGC08125	-	SGT08125
18mm Long	10.00"	.56"	.75"	SGC10750	-	SGT07625
18mm Long	10.00"	.76"	1.00"	SGC10100S	-	SGT10100S
18mm Long	10.00"	.74"	1.06"	SGC10100H	-	SGT10100H
18mm Long	12.00"	.94"	1.31"	SGC12125	-	SGT12125

\*Longer shank tine.

ADAPTER HEAD KIT 117-7198 – CONTINUED

Mount	Length	Core Dia. (ID)	OD	Part	Adapter Sleeve	Replacement Tube
<i>SOLID TINES</i>						
12mm	8.00"	–	12mm	SGS08500	–	–
12mm	10.75"	–	12mm	SGS10504	–	–
12mm	12.25"	–	12mm	SGS10500	–	–
12mm	14.25"	–	12mm	SGS12500	–	–
12mm	16.25"	–	12mm	SGS14500	–	–
18mm	12.25"	–	18mm	SGS10750	–	–
18mm	12.50"	–	.875"	SGS10875	–	–
18mm	14.00"	–	.875"	SGS12875	–	–
18mm	14.25"	–	18mm	SGS12750	–	–
18mm	16.00"	–	.875"	SGS14875	–	–
18mm	16.25"	–	18mm	SGS14750	–	–

# COMPETITIVE MODELS



### TITAN® Conversion Sleeves

Part Number	Description	Mount
112-1300	Sleeve	1/2"
112-1301	Sleeve	5/8"

Easily Converts TITAN® Tines to 1/2" and 5/8" mount. Toro® conversion sleeves allow the complete selection of Toro tines to fit on most competitive equipment. The conversion sleeve slides onto a 3/8" mount Toro tine to create a 1/2" mount or 5/8" mount.

**TITAN® TINES COMPETITIVE MODELS**

3/8" MOUNT					TITAN® Max		Competitive Model	
Length	Core Dia. (ID)	OD	Part Number	Wall	Part Number	Core Dia. (ID)	Ryan® GA 24/30/60	John Deere®
<i>TITAN QUAD</i>					<i>QUAD MAX</i>			
4.50"	.25"	.36"	108-9104	.052"	108-9112	.23"	X	X
4.50"	.32"	.46"	108-9105	.063"	108-9114	.28"	X	X
4.50"	.41"	.55"	108-9106	.063"	108-9116	.38"	X	X
4.50"	.48"	.58"	108-9293	.049"			X	X
5.00"	.25"	.36"	108-9108	.052"	108-9120	.23"	X	X
5.00"	.32"	.46"	108-9109	.063"	108-9122	.28"	X	X
5.00"	.41"	.55"	108-9110	.063"	108-9124	.38"	X	X
5.00"	.48"	.58"	108-9294	.049"			X	X
<i>TITAN SOLID ROUND</i>								
4.50"	-	.20"	108-9230	-			X	X
4.50"	-	.25"	108-9231	-			X	X
4.50"	-	.30"	108-9232	-			X	X
4.50"	-	.38"	108-9233	-			X	X
5.50"	-	.20"	108-9234	-			X	X
5.50"	-	.25"	108-9235	-			X	X
5.50"	-	.30"	108-9236	-			X	X
5.50"	-	.38"	108-9237	-			X	X
<i>TITAN SOLID SLICING</i>								
5.00"	-	.63"	108-9238	-			X	X
<i>TITAN CROSS</i>					<i>CROSS MAX</i>			
4.50"	-	.38"	108-9215	-			X	X
4.50"	-	.50"	108-9216	-	112-1310	-	X	X
4.50"	-	.62"	108-9217	-			X	X
5.50"	-	.38"	108-9218	-			X*	X
5.50"	-	.50"	108-9219	-	112-1311	-	X*	X
5.50"	-	.62"	108-9220	-			X*	X

\*Only available on GA 30/60 models

**TITAN® TINES COMPETITIVE MODELS**

1/2" MOUNT					TITAN® Max		Competitive Model	
Length	Core Dia. (ID)	OD	Part Number	Wall	Part Number	Core Dia. (ID)	Ryan® GA 24/30/60	John Deere®
<i>TITAN QUAD</i>					<i>QUAD MAX</i>			
4.50"	.32"	.46"	112-1316	.063"	112-1322	.28"	X	
<i>TITAN SOLID ROUND</i>								
4.50"	-	.50"	112-1347	-			X	
5.50"	-	.25"	112-1329	-			X	
5.00"	-	.38"	112-1330	-			X	
<i>TITAN CROSS</i>								
4.50"	-	.50"	112-5104	-			X	
5.50"	-	.50"	112-5105	-			X*	
<i>TITAN SOLID SLICING</i>								
5.00"	-	.63"	112-5102	-			X	
<i>TITAN QUAD</i>					<i>QUAD MAX</i>			
4.50"	.32"	.46"	112-1316	.063"	112-1322	.28"	X	
5/8" MOUNT					TITAN® Max		Competitive Model	
Length	Core Dia. (ID)	OD	Part Number	Wall	Part Number	Core Dia. (ID)	Ryan® GA 24/30/60	John Deere®
<i>TITAN HOLLOW</i>					<i>HOLLOW MAX</i>			
4.50"	.43"	.56"	112-1306	.058"	112-1307	.38"	X	
<i>TITAN SIDE EJECT</i>					<i>SIDE EJECT MAX</i>			
4.50"	.43"	.56"	112-1303	.058"	112-1304	.38"	X	
<i>TITAN SOLID ROUND</i>								
4.50"	-	.63"	112-1348	-			X	
<i>TITAN CROSS</i>								
4.50"	-	.50"	112-5106	-			X	
5.50"	-	.50"	112-5107	-			X*	
<i>TITAN SOLID SLICING</i>								
5.00"	-	.63"	112-5103	-			X	

\*Only available on GA 30/60 models

TITAN® TINES COMPETITIVE MODELS

3/4" MOUNT

Length	Core Dia. (ID)	OD	Part Number	Wall
<i>TITAN HOLLOW</i>				
4.75"	.28"	.46"	108-9128	.058"
4.75"	.41"	.56"	108-9129	.058"
4.75"	.53"	.66"	108-9130	.058"
5.75"	.28"	.46"	108-9132	.058"
5.75"	.41"	.56"	108-9133	.058"
5.75"	.53"	.66"	108-9134	.058"
<i>TITAN HOLLOW EXT. TAPER</i>				
5.75"	.53"	.66"	114-0551	.058"
<i>TITAN SIDE EJECT</i>				
4.75"	.28"	.46"	108-9159	.058"
4.75"	.41"	.56"	108-9160	.058"
4.75"	.53"	.66"	108-9161	.058"
5.75"	.28"	.46"	108-9163	.058"
5.75"	.41"	.56"	108-9164	.058"
5.75"	.53"	.66"	108-9165	.058"
<i>TITAN SIDE EJECT EXT. TAPER</i>				
5.75"	.53"	.66"	114-0555	.058"
<i>TITAN FAIRWAY HD</i>				
5.75"	.51"	.77"	108-9260	.120"
5.75"	.51"	.88"	108-9261	.120"
<i>TITAN FAIRWAY</i>				
5.75"	.51"	.77"	104-9876	.120"
5.75"	.51"	.88"	104-9875	.120"
<i>CLASSIC</i>				
4.75"	.30"	.44"	59-3690 Discontinued	.035"
4.75"	.40"	.50"	66-9140	.049"
4.75"	.50"	.63"	59-3670	.049"
5.75"	.51"	.63"	104-0984	.058"
<i>TITAN SOLID ROUND</i>				
4.50"	-	.25"	108-9198	-
4.50"	-	.30"	108-9199	-
4.50"	-	.35"	108-9200	-
4.50"	-	.40"	108-9201	-
4.50"	-	.50"	108-9202	-
4.50"	-	.60"	108-9203	-
5.50"	-	.25"	108-9204	-
5.50"	-	.30"	108-9205	-
5.50"	-	.35"	108-9206	-
5.50"	-	.40"	108-9207	-
5.50"	-	.50"	108-9208	-
5.50"	-	.60"	108-9209	-
5.50"	-	.75"	108-9244	-

TITAN® Max

Part Number	Core Dia. (ID)
<i>HOLLOW MAX</i>	
108-9139	.28"
108-9141	.38"
108-9143	.48"
108-9145	.28"
108-9147	.38"
108-9149	.48"
<i>HOLLOW EXT. TAPER MAX</i>	
114-0553	.47"
<i>SIDE EJECT MAX</i>	
108-9170	.28"
108-9172	.38"
108-9174	.48"
108-9176	.28"
108-9178	.38"
108-9180	.48"
<i>SIDE EJECT EXT. TAPER</i>	
114-0557	.47"

Competitive Model

Ryan® GA 24/30/60	John Deere®
X	X
X	X
X	X
X*	X
X*	X
X*	X
X*	X
X	X
X	
X	
	X
	X
	X
	X
X	
X*	X
X*	X
	X
	X
X	X
X	X
X	X
X*	X
X	X
X	X
X	X
X	X
X	X
X*	X
X*	X
X*	X
X*	X
X*	X
X*	X
X*	X
X*	X
X*	X
X*	X

TITAN® TINES COMPETITIVE MODELS

3/4" MOUNT – CONTINUED

Length	Core Dia. (ID)	OD	Part Number	Wall
<i>TITAN SOLID SLICING</i>				
4.50"	-	.75"	108-9239	-
5.50"	-	.75"	108-9240	-
<i>TITAN CROSS</i>				
4.50"	-	.50"	108-9221	-
4.50"	-	.63"	108-9222	-
4.50"	-	.75"	108-9223	-
5.50"	-	.50"	108-9224	-
5.50"	-	.63"	108-9225	-
5.50"	-	.75"	108-9226	-
7/8" Mount				
<i>TITAN HOLLOW</i>				
4.75"	.51"	.66"	108-9190	.058"
4.75"	.63"	.76"	108-9191	.058"
5.75"	.51"	.66"	108-9192	.058"
5.75"	.63"	.76"	108-9193	.058"
<i>TITAN SIDE EJECT</i>				
4.75"	.51"	.66"	108-9194	.058"
4.75"	.63"	.76"	108-9195	.058"
5.75"	.51"	.66"	108-9196	.058"
5.75"	.63"	.76"	108-9197	.058"
<i>TITAN FAIRWAY HD</i>				
5.75"	.64"	.88"	108-9264	.122"
5.75"	.64"	1.0"	108-9265	.122"
<i>TITAN FAIRWAY</i>				
4.75"	.64"	.88"	92-7941	.122"
5.75"	.64"	.88"	92-7900	.122"
5.75"	.64"	1.0"	104-9877	.120"
<i>CLASSIC</i>				
4.75"	.60"	.75"	62-4600	.065"
5.75"	.60"	.75"	86-9720	.065"
<i>TITAN SOLID ROUND</i>				
5.50"	-	.75"	108-9246	-
5.50"	-	.88"	108-9247	-
<i>TITAN SOLID SLICING</i>				
5.50"	-	.75"	108-9242	-
<i>TITAN CROSS</i>				
5.50"	-	.88"	108-9259	-

TITAN® Max

Part Number	Core Dia. (ID)
<i>CROSS MAX</i>	
112-1312	-
<i>HOLLOW MAX</i>	
108-9155	.48"
108-9157	.48"
<i>SIDE EJECT MAX</i>	
108-9186	.48"
108-9188	.48"

Competitive Model

Ryan® GA 24/30/60	John Deere®
X	X
X*	X
X	X
X	X
X	X
X*	X
X*	X
X*	X
X*	X
X*	X
X*	X
X*	X
X*	X
X*	X
X*	X
X*	X
X*	X
X*	X
X*	X
X*	X
X*	X
X*	X
X*	X
X*	X
X*	X
X*	X
X*	X
X*	X
X*	X
X*	X
X*	X
X*	X
X*	X
X*	X

\*Only available on GA 30/60 models





**QUICK REFERENCE**

Mount	Length	ID	OD	Wall Thickness	Part Number	TITAN® Max Part Number
<b>TITAN Quad &amp; Quad Max</b>						
1/2"	4.50"	.32"	.46"	.063"	112-1316	
3/8"	4.50"	.25"	.36"	.052"	108-9104	108-9112
3/8"	4.50"	.32"	.46"	.063"	108-9105	108-9114
3/8"	4.50"	.41"	.55"	.063"	108-9106	108-9116
3/8"	4.50"	.48"	.58"	.049"	108-9293	
3/8"	5.00"	.25"	.36"	.052"	108-9108	108-9120
3/8"	5.00"	.32"	.46"	.063"	108-9109	108-9122
3/8"	5.00"	.41"	.55"	.063"	108-9110	108-9124
3/8"	5.00"	.48"	.58"	.049"	108-9294	
3/8"	5.50"	.41"	.55"	.063"	108-9290	

**TITAN Hollow & Hollow Max**

3/4"	4.75"	.28"	.46"	.058"	108-9128	108-9139
3/4"	4.75"	.41"	.56"	.058"	108-9129	108-9141
3/4"	4.75"	.53"	.66"	.058"	108-9130	108-9143
3/4"	5.75"	.28"	.46"	.058"	108-9132	108-9145
3/4"	5.75"	.41"	.56"	.058"	108-9133	108-9147
3/4"	5.75"	.53"	.66"	.058"	108-9134	108-9149
3/4"	6.50"	.28"	.46"	.058"	108-9138	108-9135
3/4"	6.50"	.41"	.56"	.058"	108-9136	108-9151
3/4"	6.50"	.53"	.66"	.058"	108-9137	108-9153
5/8"	4.50"	.43"	.56"	.058"	112-1306	
7/8"	4.75"	.51"	.66"	.058"	108-9190	108-9155
7/8"	4.75"	.63"	.76"	.058"	108-9191	
7/8"	5.75"	.51"	.66"	.058"	108-9192	108-9157
7/8"	5.75"	.63"	.76"	.058"	108-9193	

**TITAN Hollow Ext. Taper & Ext. Taper Max**

3/4"	5.75"	.47"	.68"	.058"	114-0553	
3/4"	5.75"	.53"	.66"	.058"	114-0551	114-0553
3/4"	6.50"	.47"	.68"	.058"	114-0561	
3/4"	6.50"	.53"	.66"	.058"	114-0550	114-0561

**TITAN Side Eject & Side Eject Max**

3/4"	4.75"	.28"	.46"	.058"	108-9159	108-9170
3/4"	4.75"	.41"	.56"	.058"	108-9160	108-9172
3/4"	4.75"	.53"	.66"	.058"	108-9161	108-9174
3/4"	5.75"	.28"	.46"	.058"	108-9163	108-9176
3/4"	5.75"	.41"	.56"	.058"	108-9164	108-9178
3/4"	5.75"	.53"	.66"	.058"	108-9165	108-9180
3/4"	6.50"	.28"	.46"	.058"	108-9162	108-9166
3/4"	6.50"	.41"	.56"	.058"	108-9167	108-9182
3/4"	6.50"	.53"	.66"	.058"	108-9168	108-9184
5/8"	4.50"	.43"	.56"	.058"	112-1303	
7/8"	4.75"	.51"	.66"	.058"	108-9194	108-9186
7/8"	4.75"	.63"	.76"	.058"	108-9195	
7/8"	5.75"	.51"	.66"	.058"	108-9196	108-9188
7/8"	5.75"	.63"	.76"	.058"	108-9197	

**TITAN Side Eject Ext. Taper & Ext. Taper Max**

3/4"	5.75"	.53"	.66"	.058"	114-0555	114-0557
3/4"	6.50"	.53"	.66"	.058"	114-0558	114-0560

**QUICK REFERENCE**

Mount	Length	ID	OD	Wall Thickness	Part Number	TITAN® Max Part Number
<b>Classic Hollow</b>						
3/4"	4.75"	.30"	.44"	.035"	59-3690	Discontinued
3/4"	4.75"	.40"	.50"	.049"	66-9140	
3/4"	4.75"	.50"	.63"	.049"	59-3670	
3/4"	5.75"	.51"	.63"	.058"	104-0984	
3/4"	6.50"	.51"	.63"	.058"	106-8943	Discontinued
3/4"	6.50"	.39"	.66"	.058"	105-1180	
7/8"	4.75"	.60"	.75"	.065"	62-4600	
7/8"	5.75"	.60"	.75"	.065"	86-9720	

**Fairway**

3/4"	5.75"	.51"	.77"	.120"	104-9876	
3/4"	5.75"	.51"	.88"	.120"	104-9875	
7/8"	4.75"	.64"	.88"	.122"	92-7941	
7/8"	5.75"	.64"	.88"	.122"	92-7900	
7/8"	5.75"	.64"	1.0"	.120"	104-9877	

**TITAN HD Fairway**

3/4"	5.75"	.51"	.77"	.120"	108-9260	
3/4"	5.75"	.51"	.88"	.120"	108-9261	
7/8"	5.75"	.64"	.88"	.122"	108-9264	
7/8"	5.75"	.64"	1.0"	.122"	108-9265	

**TITAN Split**

3/4"	5.75"	.51"	.88"	.120"	112-5122	
7/8"	5.75"	.64"	.88"	.120"	112-5121	
7/8"	5.75"	.64"	.92"	.120"	112-5123	

**TITAN Solid Round**

1/2"	4.50"	-	.50"	-	112-1347	
1/2"	5.00"	-	.38"	-	112-1330	
1/2"	5.50"	-	.25"	-	112-1329	
3/4"	4.50"	-	.25"	-	108-9198	
3/4"	4.50"	-	.30"	-	108-9199	
3/4"	4.50"	-	.35"	-	108-9200	
3/4"	4.50"	-	.40"	-	108-9201	
3/4"	4.50"	-	.50"	-	108-9202	
3/4"	4.50"	-	.60"	-	108-9203	
3/4"	5.50"	-	.25"	-	108-9204	
3/4"	5.50"	-	.30"	-	108-9205	
3/4"	5.50"	-	.35"	-	108-9206	
3/4"	5.50"	-	.40"	-	108-9207	
3/4"	5.50"	-	.50"	-	108-9208	
3/4"	5.50"	-	.60"	-	108-9209	
3/4"	5.50"	-	.75"	-	108-9244	
3/4"	6.50"	-	.30"	-	108-9210	
3/4"	6.50"	-	.35"	-	108-9211	
3/4"	6.50"	-	.40"	-	108-9212	
3/4"	6.50"	-	.50"	-	108-9213	
3/4"	6.50"	-	.60"	-	108-9214	
3/4"	6.50"	-	.75"	-	108-9245	
3/8"	4.50"	-	.20"	-	108-9230	
3/8"	4.50"	-	.25"	-	108-9231	
3/8"	4.50"	-	.30"	-	108-9232	
3/8"	4.50"	-	.38"	-	108-9233	
3/8"	5.50"	-	.20"	-	108-9234	
3/8"	5.50"	-	.25"	-	108-9235	
3/8"	5.50"	-	.30"	-	108-9236	
3/8"	5.50"	-	.38"	-	108-9237	
5/8"	4.50"	-	.63"	-	112-1348	
7/8"	5.50"	-	.75"	-	108-9246	
7/8"	5.50"	-	.88"	-	108-9247	
7/8"	6.50"	-	.75"	-	108-9248	
7/8"	6.50"	-	.88"	-	108-9249	

**QUICK REFERENCE**

Mount	Length	ID	OD	Wall Thickness	Part Number	TITAN® Max Part Number
<i>TITAN Solid Slicing</i>						
1/2"	5.00"	-	.63"	-	112-5102	
3/4"	4.50"	-	.75"	-	108-9239	
3/4"	5.50"	-	.75"	-	108-9240	
3/4"	6.50"	-	.75"	-	108-9241	
3/8"	5.00"	-	.63"	-	108-9238	
5/8"	5.00"	-	.63"	-	112-5103	
7/8"	5.50"	-	.75"	-	108-9242	
7/8"	6.50"	-	.75"	-	108-9243	

Mount	Length	ID	OD	Wall Thickness	Part Number	TITAN® Max Part Number
<i>TITAN Cross &amp; Cross Max</i>						
1/2"	4.50"	-	.50"	-	112-5104	
1/2"	5.50"	-	.50"	-	112-5105	
3/4"	4.50"	-	.50"	-	108-9221	112-1312
3/4"	4.50"	-	.63"	-	108-9222	
3/4"	4.50"	-	.75"	-	108-9223	
3/4"	5.50"	-	.50"	-	108-9224	112-1313
3/4"	5.50"	-	.63"	-	108-9225	
3/4"	5.50"	-	.75"	-	108-9226	
3/4"	6.50"	-	.50"	-	108-9227	112-1314
3/4"	6.50"	-	.62"	-	108-9228	
3/4"	6.50"	-	.75"	-	108-9229	
3/8"	4.50"	-	.38"	-	108-9215	
3/8"	4.50"	-	.50"	-	108-9216	112-1310
3/8"	4.50"	-	.62"	-	108-9217	
3/8"	5.50"	-	.38"	-	108-9218	
3/8"	5.50"	-	.50"	-	108-9219	112-1311
3/8"	5.50"	-	.62"	-	108-9220	
5/8"	4.50"	-	.50"	-	112-5106	
5/8"	5.50"	-	.50"	-	112-5107	
7/8"	5.50"	-	.88"	-	108-9259	

Mount	Length	ID	OD	Wall Thickness	Part Number	TITAN® Max Part Number
<i>TITAN Needle Tine</i>						
Needle	6.43"	-	.188"	-	100-3620	
Needle	7.38"	-	.313"	-	100-3621	
Needle	5.43"	-	5mm	-	125-3319	

**QUICK REFERENCE**

Mount	Length	ID	OD	Wall Thickness	Part Number	TITAN® Max Part Number
<i>SR Series Deep Tine</i>						
5/16"	10.00"	-	.31"	-	SGS08313	
5/16"	8.50"	-	.31"	-	SGS07313	
12 mm	10.00"	.56"	.75"	-	SGC10754	
12 mm	10.00"	.56"	.75"	-	SGC10755*	
12 mm	10.00"	.56"	.81"	-	SGC10813H	
12 mm	10.75"	-	.47"	-	SGS10504	
12 mm	12.25"	-	.47"	-	SGS10500	
12 mm	14.25"	-	.47"	-	SGS12500	
12 mm	16.25"	-	.47"	-	SGS14500	
12 mm	7.00"	.52"	.69"	-	SGC07624	
12 mm	7.00"	.52"	.69"	-	SGC07625*	
12 mm	7.00"	.56"	.81"	-	SGC07754	
12 mm	7.00"	.56"	.81"	-	SGC07750*	
12 mm	8.00"	-	.47"	-	SGS08500	
18 mm	10.00"	.56"	.75"	-	SGC10750	
18 mm	10.00"	.74"	1.06"	-	SGC10100H	
18 mm	10.00"	.76"	1.00"	-	SGC10100S	
18 mm	12.00"	.94"	1.31"	-	SGC12125	
18 mm	12.25"	-	.71"	-	SGS10750	
18 mm	12.50"	-	.88"	-	SGS10875	
18 mm	14.00"	-	.88"	-	SGS12875	
18 mm	14.25"	-	.71"	-	SGS12750	
18 mm	16.00"	-	.88"	-	SGS14875	
18 mm	16.25"	-	.71"	-	SGS14750	
18 mm	8.00"	.74"	1.06"	-	SGC08100H	
18 mm	8.00"	.94"	1.31"	-	SGC08125	
3/8"	10.75"	-	.38"	-	SGS10374	
3/8"	12.25"	-	.38"	-	SGS10375	
3/8"	5.50"	.38"	.50"	-	SGC05550	
3/8"	9.00"	-	.38"	-	SGS08375	
7/8"	12.00"	.94"	1.31"	-	SGC12123	
7/8"	12.50"	-	.88"	-	SGS10876	
7/8"	14.00"	-	.88"	-	SGS12876	
7/8"	15.75"	-	.88"	-	SGS14876	
7/8"	17.88"	-	1.00"	-	SGS16100	
7/8"	8.00"	.94"	1.31"	-	SGC08123	